



Proposal for
IEEE SoutheastCon 2020

PREPARED BY:

Stephen Jackson, CMP, Senior National Sales Manager
919.645.2655 • sjackson@visitraleigh.com



**Greater Raleigh
Convention and Visitors Bureau**
421 Fayetteville Street, Ste. 1505
Raleigh, NC 27601-2995
919.834.5900 | 800.849.8499
919.831.2887 FAX
www.visitRaleigh.com

We welcome your group to Raleigh, N.C.

We're excited to invite IEEE SoutheastCon 2020 to Raleigh! When you're here, you'll ask, "this is work?" You may forget you're getting so much done when every amenity is at your fingertips. That's the kind of meeting you can plan on when you book our state-of-the-art Raleigh Convention Center. Every element has been designed for your convenience and indulgence--right down to being connected to two Four-Star-quality hotels.

You'll be surrounded by engaging hangouts, shopping districts and culture spots, too, so reward yourself with a Broadway show or a cold craft beer!

Facts

History Raleigh was founded in 1792 as North Carolina's capital city. It was named for Sir Walter Raleigh, who attempted to establish the first English colony on the shores of the New World in the 1580s.

Nickname The city's founding fathers called Raleigh the "City of Oaks" and dedicated themselves to maintaining the area's wooded tracts and parks.

Population Raleigh: 431,746;
Wake County: 998,691;
Raleigh metro: 1.24 million

Size Raleigh: 145 square miles;
Wake County: 857 square miles

Climate Summers range from the upper-60s to the upper-80s; spring and fall average in the 70s; winters hit the high-20s to mid-50s. (Temperatures °F). Mean annual rainfall (inches): 45.23.



Hotels

- Check the following pages for information about hotels that have offered up great room rates for your group. The Sheraton Raleigh Hotel and Raleigh Marriott City Center are adjacent to the Raleigh Convention Center and offer up top-notch amenities for your attendees to enjoy.

Meeting and Event Space

- The sun-drenched and LEED Silver-certified Raleigh Convention Center is home to stimulating design, inspiring culture and superior service. The largest room offers up 146,843 square feet of space, a gargantuan-of-a site for general sessions. 40-plus different rooms offer an array of flexible setups.

Transportation

- RDU International Airport serves Raleigh and the Research Triangle Region of N.C. RDU's two main terminals currently offer more than 400 daily arrivals and departures on eight major airlines and low-cost carriers, with 40 other airports connected by non-stop daily flights.

[Learn more at visitRaleigh.com/rdu](http://www.visitRaleigh.com/rdu)

Things to Do

- Best known for its world-class museums, best of Broadway shows and live concerts, capital area historic sites, professional and amateur sporting events and shopping mecca status with nine major retail areas, Raleigh truly offers a variety of entertainment all in one park-like, scenic setting.

[Learn more at visitRaleigh.com/things-to-do](http://www.visitRaleigh.com/things-to-do)

Dining

- Choose from more than 1,300+ restaurants, in a wide range of prices and cuisines. So, whether you're treating yourself to a fine-dining experience or popping into a deli or looking for a great pub, dining here is a peerless mix of Foodie culture and warm, down-home service.

[Learn more at visitRaleigh.com/restaurants](http://www.visitRaleigh.com/restaurants)

Table of Contents

Hotel Room Summary
Greater Raleigh CVB Welcome Letter
Raleigh Convention Center Information
Hotel Proposals and Information
Greater Raleigh CVB Services
How to Get Here

Hotel Room Summary



Hotel Room Summary

Arrival/Departure: March 11 - 16, 2020							
Hotel/Facility	Rate(s)	Wednesday 03/11/2020	Thursday 03/12/2020	Friday 03/13/2020	Saturday 03/14/2020	Sunday 03/15/2020	Total
Raleigh Convention Center	<i>Comments: Proposal attached.</i>						
Raleigh Marriott City Center	\$189.00	25	200	225	225	10	685
	<i>Comments: Please see attached.</i>						
Residence Inn Raleigh Downtown (Opening Summer 2017)	\$179.00 - \$189.00	25	50	50	50	10	185
	<i>Comments: Hi! Please feel free to let me know if you need any additional information. Thank you for this opportunity. Emily</i>						
Sheraton Raleigh Hotel	\$179.00	25	200	225	225	10	685
	<i>Comments: Proposal attached</i>						
Totals:		75	450	500	500	30	1,555

Welcome from the Greater Raleigh Convention and Visitors Bureau



Think Raleigh!

Dear Sean,

Thanks for considering Raleigh, North Carolina, for your next event! The Raleigh area is a lively, smart and welcoming destination for conventions, meetings and events. The urban revival that accompanied the 2008 development of a new convention campus in downtown Raleigh is still going strong; this dynamic energy of Raleigh is one that your meeting attendees themselves will feel.

Raleigh has long been hailed as one of the nicest places to live in the nation. Maybe it's our incredible climate, or seemingly endless array of things to do or the genuinely welcoming people who make our area such a wonderful place to call home.

But there is also a surprisingly long list of unique things for visitors to see and experience here, whether they consider themselves adrenaline junkies, creative geniuses, foodies, lifelong learners or music maniacs. Our area has earned accolades and kudos with its appealing offerings for each—both from tourists and from convention attendees when their workday is over.

RDU International Airport has been totally redeveloped and modernized in recent years—the final phases completed in early 2014. It now exceeds air travelers' expectations for services and terminal amenities while efficiently accommodating 9+ million passengers each year.

If you are meeting in downtown Raleigh, you'll see our Silver LEED-Certified Raleigh Convention Center, a catalyst for downtown's renaissance. Connected to it via interior walkways, the full-service Raleigh Marriott City Center joins the adjacent Sheraton Raleigh Hotel in providing top-notch accommodations. A third hotel, this one an extended-stay property, is actively under development on Lenoir St.

Just outside these hotels' lobbies, City Plaza is an outdoor gathering place that's a hub for socialization amid public artwork and food kiosks. Also nearby, the 5,500-seat Raleigh Amphitheater puts a larger, open-air festival site right in downtown Raleigh's convention campus and complements the indoor venues of the Duke Energy Center for the Performing Arts.

Whether you choose Raleigh, the town of Cary or the surrounding area for your stay, we believe you'll find that the Raleigh area really is the "can't miss" cultural and entertainment center of the Southeast for leisure, business and events. We invite you to experience the whole area for yourself, and please let me or the staff of the Greater Raleigh CVB know how best to assist with your plans!

Sincerely,

A handwritten signature in black ink, appearing to read "Dennis Edwards".

Dennis Edwards
President and CEO
Greater Raleigh Convention and Visitors Bureau

Think Raleigh!

Greetings, Sean,

The Greater Raleigh Convention and Visitors Bureau enthusiastically extends an invitation to host the IEEE SoutheastCon 2020, 03/11/2020-03/16/2020. We appreciate the opportunity to bid on this event.

Raleigh has long been hailed as one of the nicest places to live in the nation. Maybe it's our incredible climate, seemingly-endless array of things to do or the genuinely-welcoming people who make our area such a wonderful place to call home.

Sun-drenched and LEED Silver-certified, the Raleigh Convention Center is home to stimulating design, inspiring culture and superior service. Boasting 500,000 square feet of total space, the center offers space from small meetings to large and is connected to the Raleigh Marriott City Center. The Raleigh Marriott City Center and the adjacent Sheraton Raleigh Hotel offer top-notch accommodations.

One of our most outstanding assets is our Bureau staff. In Raleigh you will get quality service from an exceptional staff of 28 professionals. We are eager and available to provide an array of services and assistance.

You will also learn that our entire area works together as a team, and our hospitality industry will go out of its way to make your meetings successes. We want you to enjoy yourself so much that you will come back--whether it is for business or pleasure.

Thank you for the opportunity to bid on your event. We welcome you to our city!

Sincerely,



Stephen Jackson
Senior National Sales Manager
Greater Raleigh Convention and Visitors Bureau

Raleigh Convention Center Information



Where to Meet



Raleigh Convention Center

500 S. Salisbury St.
Raleigh, North Carolina 27601

Telephone: 919.996.8500
Fax: 919.996.8550
Web: raleighconvention.com



Sun-drenched and Silver LEED-certified, the Raleigh Convention Center’s campus reflects its city’s unwavering commitment to innovation and world-class service. The Center itself is 500,000 square feet of dazzling event space—an impressive, street-level lobby, a massive exhibit hall and elegant ballroom—surrounded by bustling, energized eateries, museums and entertainment throughout downtown Raleigh. The convention campus includes the Raleigh Marriott City Center and, just steps away, the Sheraton Raleigh Hotel, with additional hotels currently in development. Not to mention a fully-equipped, 5,000-seat amphitheater and Duke Energy Center for the Performing Arts.

So your next meeting, whether you’re an exhibitor, planner or attendee, will be steeped in innovation and discovery. And every moment will be enhanced by our staff’s commitment to service and satisfaction.

- 150,000-square-foot Exhibition Hall, technologically advanced and easily divisible into three sections.
- 32,000-square-foot Grand Ballroom with adjacent reception area.
- 20 individual meeting rooms, totaling over 32,000 square feet.
- Beautifully-designed, easy-to-navigate spaces create a seamless experience for guests.
- 4,000 nearby parking spaces—900 in the attached garage—make for easy coming and going.

RALEIGH CONVENTION CENTER

Right: Our 150,000-square-foot exhibit hall was the perfect showcase for NHL All-Star Weekend.

Below left: The impressive exhibit hall offers unobstructed views and enough room for 790 booths—or 24 volleyball courts.

Below center: The magnificent 32,000-square-foot ballroom sets the stage for a perfect event with its soaring ceilings and dramatic alcoves.

Below right: Red Hat Amphitheater, just across the street from the Convention Center, hosts a full slate of nationally-known touring groups and artists.



Bryan Regan



Bryan Regan

Exhibit Hall

ROOM	AREA (SF)	BOOTH (10'X10')	BANQUET SEATING (10 PER TABLE)	THEATER SEATING	SEMINAR SEATING (18" TABLES)
A+B+C	146,843	790	12,000	15,000	N/A
A	45,638	248	3,580	4,576	N/A
B	54,269	296	4,300	5,720	N/A
C	46,936	246	3,840	4,680	N/A
A+B	99,907	544	8,140	9,500	N/A
B+C	101,205	542	8,400	9,500	N/A

Meeting Rooms

201	1,424	N/A	80	158	98
202	776	N/A	30	86	53
203	814	N/A	40	90	55
204	795	N/A	40	88	54
205	826	N/A	40	94	57
206	1,381	N/A	80	153	95
301A+B	3,495	N/A	250	387	239
301A	1,758	N/A	100	194	120
301B	1,737	N/A	100	193	119
302A+B+C	5,367	N/A	400	596	368
A	1,847	N/A	100	205	126
B	1,771	N/A	100	197	121
C	1,749	N/A	100	194	120
302A+B	3,618	N/A	225	402	232
302B+C	3,520	N/A	225	391	232
303	1,716	N/A	90	190	140
304	2,257	N/A	140	260	155
305A+B	3,682	N/A	225	406	232
305A	1,847	N/A	100	203	120
305B	1,835	N/A	100	203	120
306A+B+C	5,538	N/A	400	611	384
306A	1,846	N/A	100	203	128
306B	1,846	N/A	100	203	128
306C	1,846	N/A	100	205	128
306A+B	3,692	N/A	225	406	256
306B+C	3,692	N/A	225	407	256
307	701	N/A	30	77	48
402	3,829	N/A	180	363	232

Ballroom

ROOM	AREA (SF)	BOOTH (10'X10')	BANQUET SEATING (10 PER TABLE)	THEATER SEATING	SEMINAR SEATING (18" TABLES)
A,B,C	32,617	161	2,000	3,630	3,016
A	10,105	42	550	1,123	936
B	12,440	60	700	1,388	1,092
C	10,072	42	550	1,119	884
A+B	22,545	110	1,300	2,511	2,080
B+C	22,512	110	1,300	2,507	2,080
Lobby	11,500	25	N/A	N/A	N/A

RALEIGH CONVENTION CENTER

Exhibit Hall (Level 1)

Features

- 150,000 square feet of contiguous space, easily divided into three halls
- Flexible hall configurations accommodating up to 790 10'x10' booths
- Seating for 12,000 banquet-style; 15,000 theater-style
- 12 covered loading docks and numerous ramps for direct drive-in access to exhibit halls
- State-of-the-art lighting, sound and telecommunications

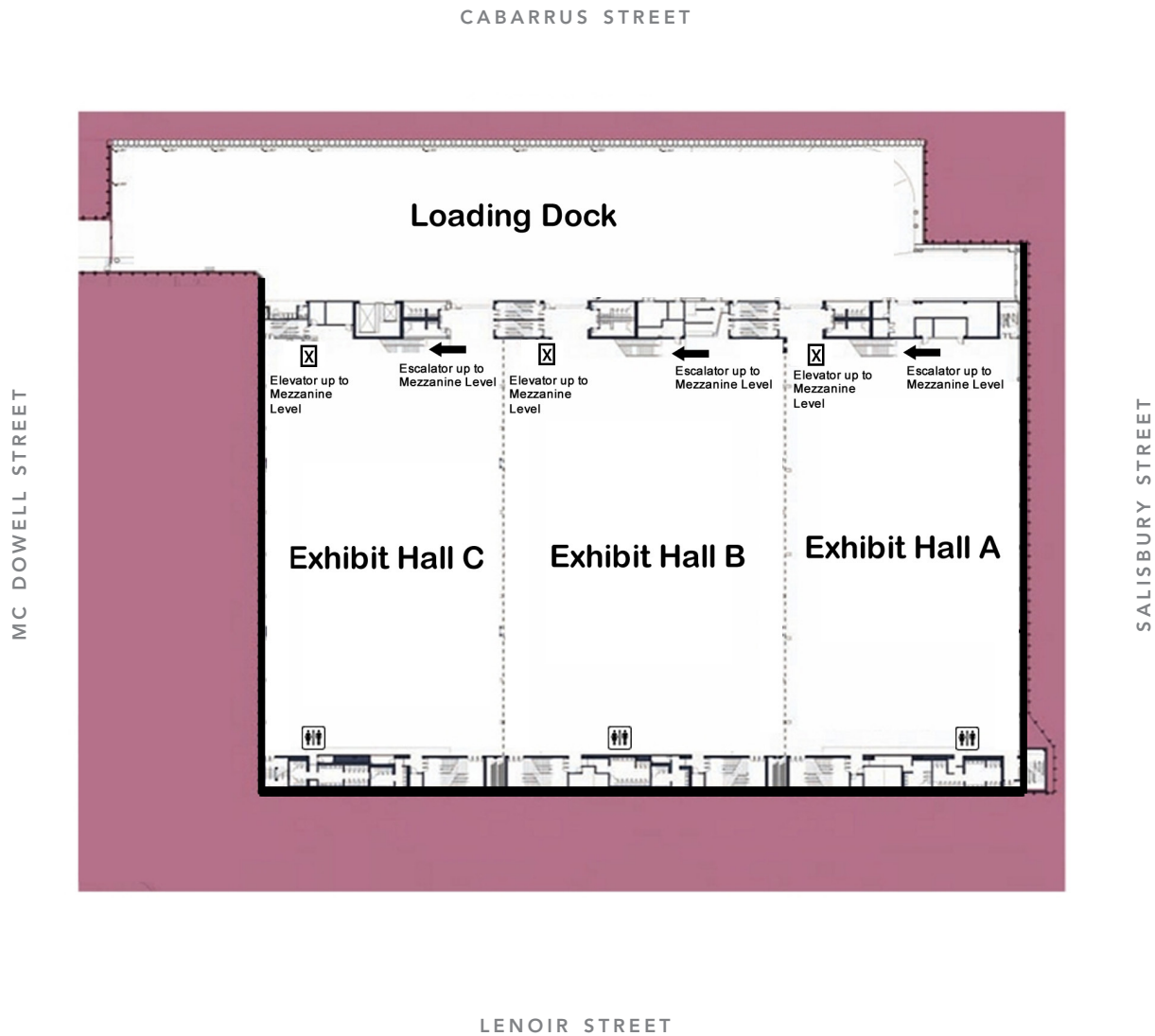

Legend:

- Stairs
- Escalators
- Elevator

Level 4
Level 3
Level 2
Level 1

RALEIGH CONVENTION CENTER

Mezzanine (Level 2)

Features

- 4,100 square feet
- Street level access
- Reception area overlooking exhibit hall floor
- Six individual meeting rooms

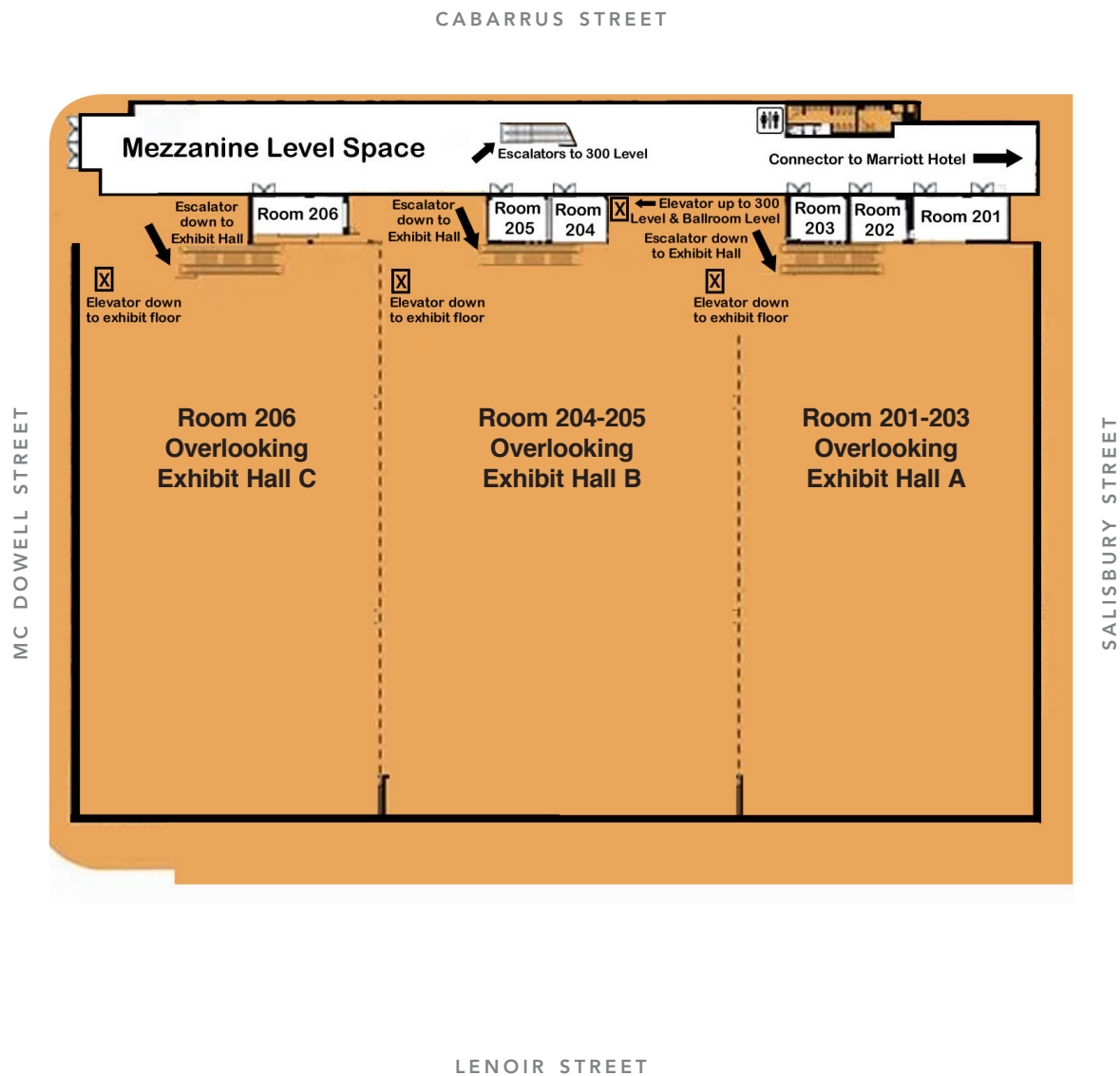

Stairs

Escalators

Elevator

level 4

level 3

level 2

level 1

RALEIGH CONVENTION CENTER

Meeting Rooms (Level 3)

Features

- 32,601 square feet of meeting space
- Special meeting room with executive-level amenities
- 13 meeting rooms located on street level
- Full back-of-house service



RALEIGH CONVENTION CENTER

Ballroom (Level 4)

Features

- 32,617-square-foot ballroom divisible into three separate rooms
- Seating for 3,630 theater-style or 2,000 banquet-style
- Adjacent 11,500-square-foot reception area
- Special meeting room with executive-level amenities

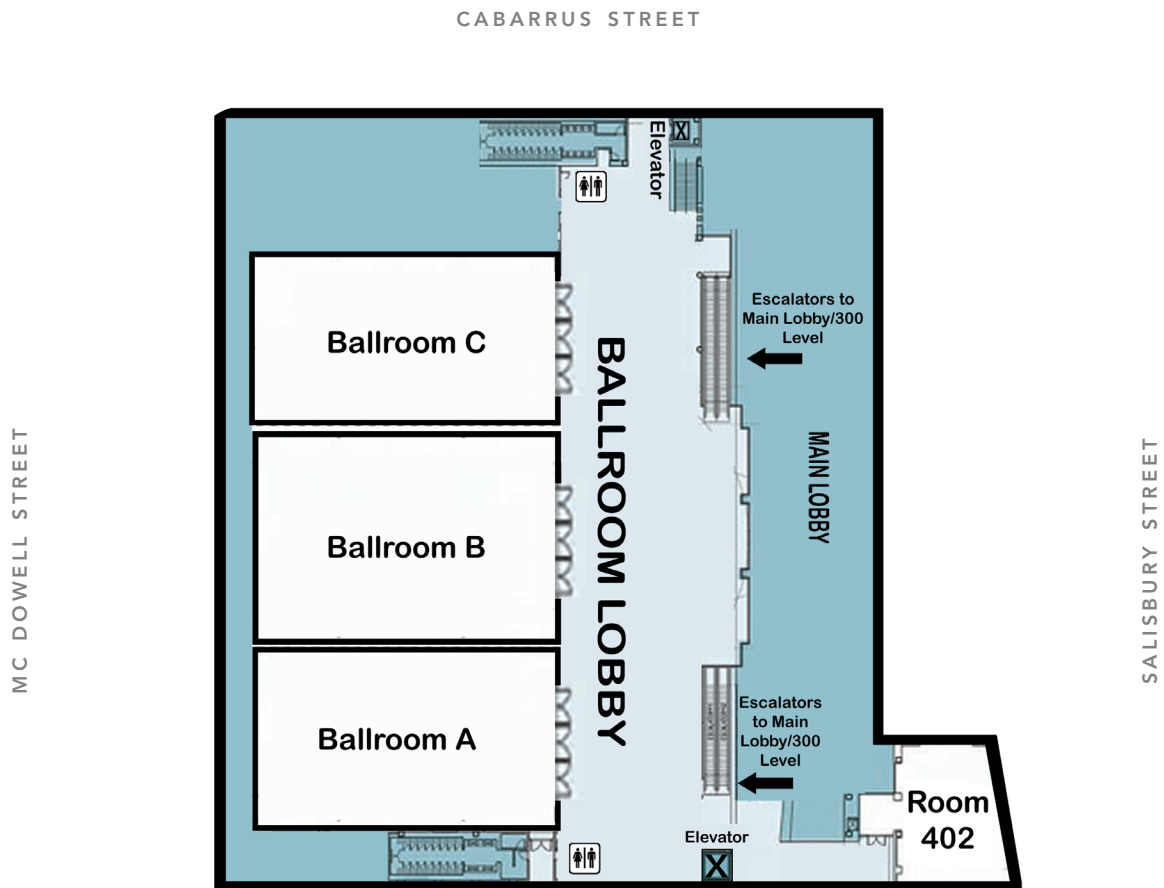

LENOIR STREET

Legend:

- Stairs (Green square icon)
- Escalators (Blue triangle icon)
- Elevator (Red square icon)

Level color key:

- level 4 (Blue)
- level 3 (Green)
- level 2 (Yellow)
- level 1 (Red)

April 24, 2017

Mr. Sean A.R. Haynes
IEEE Region 3 Conference Committee Chair
2407 Hillwood Place
Charlottesville, VA 22901-2920



RE: IEEE 2020 SoutheastCon

Dear Mr. Haynes:

The Raleigh Convention Center is excited about the opportunity to host **IEEE 2020 SoutheastCon**. The *Silver LEED Certified Raleigh Convention Center* consists of 150,000 square feet of exhibit space, 32,000 square feet of meeting space that is divisible into 20 rooms, 32,000 square feet of elegant ballroom space that is divisible into 3 rooms, and an abundance of naturally lit pre-function space. For more information, floor plans or to view a virtual tour of the RCC, please visit us at <http://www.raleighconvention.com>.

Centerplate, the exclusive caterer for the RCC, brings over 45 years of catering and food, beverage and concession services to our guests. Current Menus are available on our website: <http://www.raleighconvention.com/catering/menus>.

At the present time, the Raleigh Convention Center is available on **March 11-15, 2020**. Should another group express interest for the same dates listed, we will contact you for your decision and permit 48 hours to either agree to contract terms or release space. On the following page we have outlined suggested space utilizations for this Conference based on the information provided. **We have offered a discounted rental of \$13,000.00 based on an \$75,000.00 F&B minimum (prior to tax and service fees)**. Your rental includes tables and chairs for all meeting room and ballroom sets (excluding exhibit sets), one (1) skirted head table per room, one (1) power drop per room, and one (1) podium with wired microphone per room. The Center does not have an in house AV company or decorator, you may work with the vendor of your choice. Please see the attached rate sheet for all other equipment and services.

Requested Proposal Inclusions/Concessions:

- **Complimentary rental via a hotel rebate per actualized room.**
- Complimentary shared wireless internet service throughout the entire building.
- No shipping/handling/storage fees for registration and meeting materials within 48 hours of event move in.
- Complimentary water coolers (that are connected to the water line) in the prefunction areas.

On behalf the management and staff of the Raleigh Convention Center, let me express our sincere wishes to have the opportunity to work with you on this exciting event. We would love the opportunity to host this conference in Raleigh! If I can be of further assistance, please do not hesitate to call.

Sincerely,

Mara Craft, National Sales Manager
Raleigh Convention Center
500 South Salisbury St. Raleigh, NC 27601
919-996-8509
Mara.Craft@raleighconvention.com
www.raleighconvention.com



Booked Spaces for IEEE SoutheastCon 2020

Start-End: 03/11/20 07:00 AM - 03/15/20 11:59 PM

Usage Description	Comment	Resource	Start Day	Start Date	Start Time	End Day	End Date	End Time	Status	Charges
Office		BusinessOffice (1178)	Wed	03/11/20	07:00 AM	Wed	03/11/20	11:59 PM	Hold (28)	Complimentary
Storage		Reg Office (ROFF)	Wed	03/11/20	07:00 AM	Wed	03/11/20	11:59 PM	Hold (28)	Complimentary
Banquet	Meals	Ballroom A (BR-A)	Thu	03/12/20	07:00 AM	Thu	03/12/20	11:59 PM	Hold (28)	Complimentary F&B
Event	Main Ballroom	Ballroom B (BR-B)	Thu	03/12/20	07:00 AM	Thu	03/12/20	11:59 PM	Hold (28)	\$ 2,500.00
Office		BusinessOffice (1178)	Thu	03/12/20	07:00 AM	Thu	03/12/20	11:59 PM	Hold (28)	Complimentary
Breakout		MR 302A (M302A)	Thu	03/12/20	07:00 AM	Thu	03/12/20	11:59 PM	Hold (28)	\$ 250.00
Breakout		MR 302B (M302B)	Thu	03/12/20	07:00 AM	Thu	03/12/20	11:59 PM	Hold (28)	\$ 250.00
Breakout		MR 302C (M302C)	Thu	03/12/20	07:00 AM	Thu	03/12/20	11:59 PM	Hold (28)	\$ 250.00
Breakout		MR 303 (M303)	Thu	03/12/20	07:00 AM	Thu	03/12/20	11:59 PM	Hold (28)	\$ 250.00
Breakout		MR 305A (M305A)	Thu	03/12/20	07:00 AM	Thu	03/12/20	11:59 PM	Hold (28)	\$ 250.00
Breakout		MR 305B (M305B)	Thu	03/12/20	07:00 AM	Thu	03/12/20	11:59 PM	Hold (28)	\$ 250.00
Breakout		MR 306A (M306A)	Thu	03/12/20	07:00 AM	Thu	03/12/20	11:59 PM	Hold (28)	\$ 250.00
Breakout		MR 306B (M306B)	Thu	03/12/20	07:00 AM	Thu	03/12/20	11:59 PM	Hold (28)	\$ 250.00
Breakout		MR 306C (M306C)	Thu	03/12/20	07:00 AM	Thu	03/12/20	11:59 PM	Hold (28)	\$ 250.00
Breakout		MR 307 (M307)	Thu	03/12/20	07:00 AM	Thu	03/12/20	11:59 PM	Hold (28)	\$ 150.00
Storage		Reg Office (ROFF)	Thu	03/12/20	07:00 AM	Thu	03/12/20	11:59 PM	Hold (28)	Complimentary
Banquet	Meals	Ballroom A (BR-A)	Fri	03/13/20	07:00 AM	Fri	03/13/20	11:59 PM	Hold (28)	Complimentary F&B
Event	Main Ballroom	Ballroom B (BR-B)	Fri	03/13/20	07:00 AM	Fri	03/13/20	11:59 PM	Hold (28)	\$ 2,500.00
Event	Junior Ballroom	Ballroom C (BR-C)	Fri	03/13/20	07:00 AM	Fri	03/13/20	11:59 PM	Hold (28)	\$ 1,500.00
Office		BusinessOffice (1178)	Fri	03/13/20	07:00 AM	Fri	03/13/20	11:59 PM	Hold (28)	Complimentary
Breakout		MR 201 (M201)	Fri	03/13/20	07:00 AM	Fri	03/13/20	11:59 PM	Hold (28)	\$ 200.00
Breakout		MR 202 (M202)	Fri	03/13/20	07:00 AM	Fri	03/13/20	11:59 PM	Hold (28)	\$ 150.00
Breakout		MR 203 (M203)	Fri	03/13/20	07:00 AM	Fri	03/13/20	11:59 PM	Hold (28)	\$ 150.00
Breakout		MR 204 (M204)	Fri	03/13/20	07:00 AM	Fri	03/13/20	11:59 PM	Hold (28)	\$ 150.00
Breakout		MR 205 (M205)	Fri	03/13/20	07:00 AM	Fri	03/13/20	11:59 PM	Hold (28)	\$ 150.00
Breakout		MR 206 (M206)	Fri	03/13/20	07:00 AM	Fri	03/13/20	11:59 PM	Hold (28)	\$ 200.00
Breakout		MR 301A (M301A)	Fri	03/13/20	07:00 AM	Fri	03/13/20	11:59 PM	Hold (28)	\$ 250.00
Breakout		MR 301B (M301B)	Fri	03/13/20	07:00 AM	Fri	03/13/20	11:59 PM	Hold (28)	\$ 250.00
Breakout		MR 302A (M302A)	Fri	03/13/20	07:00 AM	Fri	03/13/20	11:59 PM	Hold (28)	\$ 250.00
Breakout		MR 302B (M302B)	Fri	03/13/20	07:00 AM	Fri	03/13/20	11:59 PM	Hold (28)	\$ 250.00
Breakout		MR 302C (M302C)	Fri	03/13/20	07:00 AM	Fri	03/13/20	11:59 PM	Hold (28)	\$ 250.00
Breakout		MR 303 (M303)	Fri	03/13/20	07:00 AM	Fri	03/13/20	11:59 PM	Hold (28)	\$ 250.00
Breakout		MR 304 (M304)	Fri	03/13/20	07:00 AM	Fri	03/13/20	11:59 PM	Hold (28)	\$ 450.00
Breakout		MR 305A (M305A)	Fri	03/13/20	07:00 AM	Fri	03/13/20	11:59 PM	Hold (28)	\$ 250.00
Breakout		MR 305B (M305B)	Fri	03/13/20	07:00 AM	Fri	03/13/20	11:59 PM	Hold (28)	\$ 250.00
Breakout		MR 306A (M306A)	Fri	03/13/20	07:00 AM	Fri	03/13/20	11:59 PM	Hold (28)	\$ 250.00
Breakout		MR 306B (M306B)	Fri	03/13/20	07:00 AM	Fri	03/13/20	11:59 PM	Hold (28)	\$ 250.00
Breakout		MR 306C (M306C)	Fri	03/13/20	07:00 AM	Fri	03/13/20	11:59 PM	Hold (28)	\$ 250.00
Breakout		MR 307 (M307)	Fri	03/13/20	07:00 AM	Fri	03/13/20	11:59 PM	Hold (28)	\$ 150.00
Breakout		MR 402 (M402)	Fri	03/13/20	07:00 AM	Fri	03/13/20	11:59 PM	Hold (28)	\$ 650.00
Storage		Reg Office (ROFF)	Fri	03/13/20	07:00 AM	Fri	03/13/20	11:59 PM	Hold (28)	Complimentary
Banquet	Meals	Ballroom A (BR-A)	Sat	03/14/20	07:00 AM	Sat	03/14/20	11:59 PM	Hold (28)	Complimentary F&B
Event	Main Ballroom	Ballroom B (BR-B)	Sat	03/14/20	07:00 AM	Sat	03/14/20	11:59 PM	Hold (28)	\$ 2,500.00
Event	Junior Ballroom	Ballroom C (BR-C)	Sat	03/14/20	07:00 AM	Sat	03/14/20	11:59 PM	Hold (28)	\$ 1,500.00
Office		BusinessOffice (1178)	Sat	03/14/20	07:00 AM	Sat	03/14/20	11:59 PM	Hold (28)	Complimentary
Breakout		MR 201 (M201)	Sat	03/14/20	07:00 AM	Sat	03/14/20	11:59 PM	Hold (28)	\$ 200.00
Breakout		MR 202 (M202)	Sat	03/14/20	07:00 AM	Sat	03/14/20	11:59 PM	Hold (28)	\$ 150.00

Breakout		MR 203 (M203)	Sat	03/14/20	07:00 AM	Sat	03/14/20	11:59 PM	Hold (28)	\$	150.00
Breakout		MR 204 (M204)	Sat	03/14/20	07:00 AM	Sat	03/14/20	11:59 PM	Hold (28)	\$	150.00
Breakout		MR 205 (M205)	Sat	03/14/20	07:00 AM	Sat	03/14/20	11:59 PM	Hold (28)	\$	150.00
Breakout		MR 206 (M206)	Sat	03/14/20	07:00 AM	Sat	03/14/20	11:59 PM	Hold (28)	\$	200.00
Breakout		MR 301A (M301A)	Sat	03/14/20	07:00 AM	Sat	03/14/20	11:59 PM	Hold (28)	\$	250.00
Breakout		MR 301B (M301B)	Sat	03/14/20	07:00 AM	Sat	03/14/20	11:59 PM	Hold (28)	\$	250.00
Breakout		MR 302A (M302A)	Sat	03/14/20	07:00 AM	Sat	03/14/20	11:59 PM	Hold (28)	\$	250.00
Breakout		MR 302B (M302B)	Sat	03/14/20	07:00 AM	Sat	03/14/20	11:59 PM	Hold (28)	\$	250.00
Breakout		MR 302C (M302C)	Sat	03/14/20	07:00 AM	Sat	03/14/20	11:59 PM	Hold (28)	\$	250.00
Breakout		MR 303 (M303)	Sat	03/14/20	07:00 AM	Sat	03/14/20	11:59 PM	Hold (28)	\$	250.00
Breakout		MR 304 (M304)	Sat	03/14/20	07:00 AM	Sat	03/14/20	11:59 PM	Hold (28)	\$	450.00
Breakout		MR 305A (M305A)	Sat	03/14/20	07:00 AM	Sat	03/14/20	11:59 PM	Hold (28)	\$	250.00
Breakout		MR 305B (M305B)	Sat	03/14/20	07:00 AM	Sat	03/14/20	11:59 PM	Hold (28)	\$	250.00
Breakout		MR 306A (M306A)	Sat	03/14/20	07:00 AM	Sat	03/14/20	11:59 PM	Hold (28)	\$	250.00
Breakout		MR 306B (M306B)	Sat	03/14/20	07:00 AM	Sat	03/14/20	11:59 PM	Hold (28)	\$	250.00
Breakout		MR 306C (M306C)	Sat	03/14/20	07:00 AM	Sat	03/14/20	11:59 PM	Hold (28)	\$	250.00
Breakout		MR 307 (M307)	Sat	03/14/20	07:00 AM	Sat	03/14/20	11:59 PM	Hold (28)	\$	150.00
Breakout		MR 402 (M402)	Sat	03/14/20	07:00 AM	Sat	03/14/20	11:59 PM	Hold (28)	\$	650.00
Storage		Reg Office (ROFF)	Sat	03/14/20	07:00 AM	Sat	03/14/20	11:59 PM	Hold (28)		Complimentary
Banquet	Meals	Ballroom A (BR-A)	Sun	03/15/20	07:00 AM	Sun	03/15/20	11:59 PM	Hold (28)		Complimentary F&B
Event	Junior Ballroom	Ballroom C (BR-C)	Sun	03/15/20	07:00 AM	Sun	03/15/20	11:59 PM	Hold (28)	\$	1,500.00
Office		BusinessOffice (1178)	Sun	03/15/20	07:00 AM	Sun	03/15/20	11:59 PM	Hold (28)		Complimentary
Breakout		MR 302A (M302A)	Sun	03/15/20	07:00 AM	Sun	03/15/20	11:59 PM	Hold (28)	\$	250.00
Breakout		MR 302B (M302B)	Sun	03/15/20	07:00 AM	Sun	03/15/20	11:59 PM	Hold (28)	\$	250.00
Breakout		MR 302C (M302C)	Sun	03/15/20	07:00 AM	Sun	03/15/20	11:59 PM	Hold (28)	\$	250.00
Breakout		MR 303 (M303)	Sun	03/15/20	07:00 AM	Sun	03/15/20	11:59 PM	Hold (28)	\$	250.00
Breakout		MR 305A (M305A)	Sun	03/15/20	07:00 AM	Sun	03/15/20	11:59 PM	Hold (28)	\$	250.00
Breakout		MR 305B (M305B)	Sun	03/15/20	07:00 AM	Sun	03/15/20	11:59 PM	Hold (28)	\$	250.00
Breakout		MR 306A (M306A)	Sun	03/15/20	07:00 AM	Sun	03/15/20	11:59 PM	Hold (28)	\$	250.00
Breakout		MR 306B (M306B)	Sun	03/15/20	07:00 AM	Sun	03/15/20	11:59 PM	Hold (28)	\$	250.00
Breakout		MR 306C (M306C)	Sun	03/15/20	07:00 AM	Sun	03/15/20	11:59 PM	Hold (28)	\$	250.00
Breakout		MR 307 (M307)	Sun	03/15/20	07:00 AM	Sun	03/15/20	11:59 PM	Hold (28)	\$	150.00
Storage		Reg Office (ROFF)	Sun	03/15/20	07:00 AM	Sun	03/15/20	11:59 PM	Hold (28)		Complimentary
									Standard RCC Rental	\$	26,800.00
									F&B Minimum (Prior to tax and service fees)	\$	75,000.00
									Discounted Rental Total*	\$	13,000.00
*Please note rental may be offset by a hotel rebate per actualized room.											

Raleigh Convention and Performing Arts Complex

Raleigh Convention Center

FY17 Rates Effective 7/1/16

<u>Category</u> Facility	<u>Description</u>	<u>FY17</u> <u>Rate</u>	<u>Unit/</u> <u>Time</u>
	RCC - Copies (Black and White) (Each)	0.25	EA
	RCC - Copies (Color) (Each)	0.50	EA
	RCCF - 10x10 Exhibitor Booth (Each)	550.00	EA
	RCCF - Cardboard Dumpster Collection (Each)	Market	EA
	RCCF - Debris Dump (Each)	Market	EA
	RCCF - Grease Dump (Each)	250.00	EA
	RCCF - Balloon/Confetti Removal (Each)	500.00	EA
	RCCF - Safe Rental (Event)	250.00	EVT
	RCCF - 110V 20 Amp Electrical Outlet (Advance) (Event)	90.00	EVT
	RCCF - 110V 20 Amp Electrical Outlet (Floor) (Event)	140.00	EVT
	RCCF - 220V 30 Amp & Under Electrical Outlet (Advance) (Event)	160.00	EVT
	RCCF - 220V 30 Amp & Under Electrical Outlet (Floor) (Event)	220.00	EVT
	RCCF - 220V 30 Amp to 100 Amp (Advance) (Event)	240.00	EVT
	RCCF - 220V 30 Amp to 100 Amp (Floor) (Event)	320.00	EVT
	RCCF - Electrical - 208v 100 Amp Single Phase (Advance) (Event)	420.00	EVT
	RCCF - Electrical - 208v 100 Amp Single Phase (Floor) (Event)	545.00	EVT
	RCCF - Electrical - 208v 100 Amp Three Phase (Advance) (Event)	520.00	EVT
	RCCF - Electrical - 208v 100 Amp Three Phase (Floor) (Event)	680.00	EVT
	RCCF - Electrical - 208v 200 Amp Single Phase (Advance) (Event)	570.00	EVT
	RCCF - Electrical - 208v 200 Amp Single Phase (Floor) (Event)	745.00	EVT
	RCCF - Electrical - 208v 200 Amp Three Phase (Advance) (Event)	670.00	EVT
	RCCF - Electrical - 208v 200 Amp Three Phase (Floor) (Event)	875.00	EVT
	RCCF - Electrical - 208v 30 to 100 AMP (Advance) (Event)	240.00	EVT
	RCCF - Electrical - 208v 30 to 100 AMP (Floor) (Event)	320.00	EVT
	RCCF - Electrical - 208v 400 Amp Single Phase (Advance) (Event)	750.00	EVT
	RCCF - Electrical - 208v 400 Amp Single Phase (Floor) (Event)	1,010.00	EVT
	RCCF - Electrical - 208v 400 Amp Three Phase (Advance) (Event)	850.00	EVT
	RCCF - Electrical - 208v 400 Amp Three Phase (Floor) (Event)	1,110.00	EVT
	RCCF - Step Down Transformer-200 Amp-Exh Hall (Advance) (Event)	350.00	EVT
	RCCF - Step Down Transformer-200 Amp-Exh Hall (Floor) (Event)	455.00	EVT
	RCCF - Step Down Transformer-400 Amp-Exh Hall (Advance) (Event)	650.00	EVT
	RCCF - Step Down Transformer-400 Amp-Exh Hall (Floor) (Event)	845.00	EVT
	RCCF - Extension Cord/Powerstrip	25.00	DAY
	RCCF - Industrial Gas Service (Call for Approval) (Each)	Market	EA
	RCCF - Compressed Air (Each)	130.00	EA
	RCCF - Sink With Cold Water and Grease Trap	325.00	EA
	RCCF - Sink With Hot & Cold Water and Grease Trap	650.00	EA
	RCCF - Electronic Keys Not Returned (Each)	20.00	EA
	RCCF - Hard Copy Keys Not Returned (Each)	50.00	EA
	RCCF - Re-Key High Security (Per Cylinder) (Each)	100.00	EA
	RCCF - Barricades (Day)	10.00	DAY
	RCCF - 10 lb ABC Fire Extinguishers (Event)	175.00	EVT
	RCCF - Flame Retardant - Application (Each)	50.00	EA
	RCCF - Flame Retardant - Material Only (Each)	50.00	EA
	RCCF - Pallet Jacks (Manual) (Event)	25.00	EVT

Raleigh Convention and Performing Arts Complex
Raleigh Convention Center
FY17 Rates Effective 7/1/16

<u>Category</u>	<u>Description</u>	<u>FY17 Rate</u>	<u>Unit/Time</u>
	RCCF - Pallet Jacks (Electric) - 4 Hours Max (Hour)	50.00	HR
	RCCF - Scissor Lift (Day)	300.00	DAY
	RCCF - Scissor Lift (Event)	750.00	EVT
	RCCF - Fork Lift (Day)	300.00	DAY
	RCCF - Fork Lift (Event)	750.00	EVT
	RCCF - Genie Lift (Day)	300.00	DAY
	RCCF - Genie Lift (Event)	750.00	EVT
	RCCF - Water Connection (Call for Approval) (Each)	115.00	EA
	RCCF - Hot Water Connection (Call for Approval) (Each)	115.00	EA
	RCCF - Additional Water Connection (Call for Approval) (Each)	80.00	EA
	RCCF - Additional Hot Water Connection (Call for Approval) (Each)	80.00	EA
Information Technology			
	RCCC - Telephone - Digital Conference Phone (Advance) (Event)	350.00	EVT
	RCCC - Telephone - Digital Conference Phone (Floor) (Event)	425.00	EVT
	RCCC - Telephone Line - (Handset Not Incl) (Advance) (Event)	215.00	EVT
	RCCC - Telephone Line - (Handset Not Incl) (Floor) (Event)	270.00	EVT
	RCCC - Telephone - Analog Handset (Advance) (Event)	29.75	EVT
	RCCC - Telephone - Analog Handset (Floor) (Event)	35.00	EVT
	RCCF - Cable Signal Hookup (Connection) (Event)	Market	EVT
	RCCC - Wireless Internet (Day)	5.00	DAY
	RCCC - Wired Internet (Advance)(Event)	350.00	EVT
	RCCC - Wired Internet (Floor)(Event)	450.00	EVT
	RCCC - Unmanaged 8 Port Switch (Event)	50.00	EVT
	RCCC - Static IP Address (Event)	150.00	EVT
	RCCC - Shimmer Wall Color Change (Call for Approval)	100.00	EA
Audio/Visual			
	RCCF - 8' x 8' Screen (Day)	50.00	DAY
	RCCF - 8' x 8' Screen (Event)	125.00	EVT
	RCCF - LCD Projector (Day)	100.00	DAY
	RCCF - LCD Projector (Event)	250.00	EVT
	RCCF - Video Package (Day)	200.00	DAY
	RCCF - Video Package (Event)	500.00	EVT
	RCCF - Spotlight (Event)	65.00	EVT
	RCCA - Basic Sound System - Ballroom Level (Event)	500.00	EVT
	RCCA - Basic Sound System - Exhibit Hall Level (Event)	300.00	EVT
	RCCA - Basic Sound System - Meeting Room Level (Event)	200.00	EVT
	RCCA - Clear Com Headset Package (4 beltpacks/headsets) (Day)	50.00	DAY
	RCCA - Extra Microphone (Day)	50.00	DAY
	RCCA - Intercom Stand w/ 5 stations (Day)	50.00	DAY
	RCCA - Microphone (Day)	50.00	DAY
	RCCA - Microphone (Wireless) (Day)	95.00	DAY
	RCCA - Paging System (Day)	25.00	DAY
	RCCA - Wireless Lapel Microphones (Day)	95.00	DAY
	RCCS - Digital Piano - Upright (Event)	300.00	EVT

Raleigh Convention and Performing Arts Complex

Raleigh Convention Center

FY17 Rates Effective 7/1/16

<u>Category</u>	<u>Description</u>	<u>FY17 Rate</u>	<u>Unit/ Time</u>
Event Set-up			
	RCCS - Upholstered Chair (Day)	2.00	DAY
	RCCS - Wire Chair (Day)	1.00	DAY
	RCCS - Easel (Day)	10.00	DAY
	RCCS - Coat Rack w/Hangers (Day)	25.00	DAY
	RCCS - Dance Floor 3' x 3' section (Day)	9.00	DAY
	RCCS - Rope & Stanchion per set (Day)	12.00	DAY
	RCCS - Stage 6' x 8' x 4' Unit (Day)	35.00	DAY
	RCCS - Stage 8' x 8' x 4' Unit (Day)	35.00	DAY
	RCCS - Stage Ramp Unit (Day)	25.00	DAY
	RCCS - 6' x 8' x 2' Riser (Day)	27.00	DAY
	RCCS - 4' x 8' x 2' Riser (Day)	27.00	DAY
	RCCS - 8' x 18" Narrow Table (Day)	14.00	DAY
	RCCS - 8' x 18" Narrow Table (Week)	42.00	WK
	RCCS - 18" x 6' Narrow Table w/Cloth & Skirt (Event)	20.00	EVT
	RCCS - 30" x 8' Table w/Cloth & Skirt (Event)	20.00	EVT
	RCCS - 6' x 18" Table (Day)	14.00	DAY
	RCCS - 6' x 18" Table (Week)	42.00	WK
	RCCS - 72" Round Table (Day)	14.00	DAY
	RCCS - 72" Round Table (Week)	42.00	WK
	RCCS - 8' x 30" Table (Day)	14.00	DAY
	RCCS - 8' x 30" Table (Week)	42.00	WK
	RCCS - Cocktail Table (Day)	14.00	DAY
	RCCS - Cocktail Table (Week)	42.00	WK
	RCCS - Podium, Stand or Table Top (Day)	35.00	DAY
	RCCS - Table Cloths per use (Event)	6.00	EVT
	RCCS - Table Skirting - Black (Day)	5.00	DAY
	RCCS - Set Change - Ballroom/Exhibit Hall (Each)	500.00	EA
	RCCS - Set Change - Meeting Room (Each)	250.00	EA
	RCCS - Setup Fee For Outside Equipment (Each)	500.00	EA
Production/Labor*			
	RCC - Carpenter (4 Hour Minimum)	23.00	HR
	RCC - OT Rate - Carpenter (Hour)	34.75	HR
	RCC - Cashier (3 Hour Minimum)	13.00	HR
	RCC - OT Rate - Cashier (Hour)	19.50	HR
	RCC - Coat Checker (3 Hour Minimum)	11.75	HR
	RCC - OT Rate - Coat Checker (Hour)	17.75	HR
	RCC - Door Guard (3 Hour Minimum)	18.50	HR
	RCC - OT Rate - Door Guard (Hour)	27.75	HR
	RCC - Electrician (4 Hour Minimum)	30.00	HR
	RCC - OT Rate - Electrician (Hour)	45.00	HR
	RCC - Electrician - Additional Labor (Advance) (Hour)	60.00	HR
	RCC - Electrician - Additional Labor (Floor) (Hour)	105.00	HR
	RCC - EMT Service Pkg (2 EMT + Ambulance) (Hour)	105.00	HR
	RCC - Fire Personnel (3 Hour Minimum)	29.50	HR
	RCC - OT Rate - Fire Personnel (Hour)	44.25	HR

Raleigh Convention and Performing Arts Complex
Raleigh Convention Center
FY17 Rates Effective 7/1/16

<u>Category</u>	<u>Description</u>	<u>FY17</u> <u>Rate</u>	<u>Unit/</u> <u>Time</u>
	RCC - Forklift Driver (4 Hour Minimum)	23.00	HR
	RCC- OT Rate - Forklift Driver (Hour)	34.75	HR
	RCC - Head Cashier (3 Hour Minimum)	45.00	HR
	RCC - OT Rate - Head Cashier (Hour)	67.50	HR
	RCC - House Labor (4 Hour Minimum)	23.00	HR
	RCC - OT Rate - House Labor (Hour)	34.75	HR
	RCC - Housekeeping (4 Hour Minimum)	23.00	HR
	RCC - OT Rate - Housekeeping (Hour)	34.75	HR
	RCC - Houselight Operator (4 Hour Minimum)	34.75	HR
	RCC - OT Rate - Houselight Operator (Hour)	52.25	HR
	RCC - Production Supervisor (4 Hour Minimum)	50.00	HR
	RCC - OT Rate - Prod Supervisor (Hour)	75.00	HR
	RCC - Rigger (4 Hour Minimum)	23.00	HR
	RCC - OT Rate - Rigger (Hour)	34.75	HR
	RCC - Security - Raleigh Police (3 Hour Minimum)	65.00	HR
	RCC - OT Rate - Security - Raleigh Police (Hour)	97.50	HR
	RCC - Setup Personnel (4 Hour Minimum)	23.00	HR
	RCC - OT Rate - Setup Personnel (Hour)	34.75	HR
	RCC - Settlement Accountant (3 Hour Minimum)	45.00	HR
	RCC - OT Rate - Settlement Accountant (Hour)	67.50	HR
	RCC - Sound (4 Hour Minimum)	30.00	HR
	RCC - OT Rate - Sound (Hour)	45.00	HR
	RCC - Followspot Operator (4 Hour Minimum)	23.00	HR
	RCC - OT Rate - Followspot Operator (Hour)	34.75	HR
	RCC - Stagehand (4 Hour Minimum)	23.00	HR
	RCC - OT Rate - Stagehand (Hour)	34.75	HR
	RCC - T Shirt Security (3 Hour Minimum)	18.50	HR
	RCC - OT Rate - T Shirt Security (Hour)	27.75	HR
	RCC - Ticket Taker (3 Hour Minimum)	11.75	HR
	RCC - OT Rate - Ticket Taker	17.75	HR
	RCC - Truck Loader (4 Hour Minimum)	23.00	HR
	RCC - OT Rate - Truck Loader (Hour)	34.75	HR
	RCC - Usher (3 Hour Minimum)	11.75	HR
	RCC - OT Rate - Usher (Hour)	17.75	HR
	RCC - Elevator Operator (4 Hour Minimum)	23.00	HR
	RCC - OT Rate - Elevator Operator (Hour)	34.75	HR

* Overtime (Time & one-half rate) is required for work performed daily between 12 am and 8am, on Holidays and after 40 hours per week.

Hotel proposals and information



Where to Meet



Raleigh Marriott City Center

500 Fayetteville St.
Raleigh, North Carolina 27601

Telephone: 919.833.1120
Fax: 919.334.0290
Web: marriott.com/rdumc

Vital statistics

# of Sleeping Rooms	400
# of Suites	10
# of Meeting Rooms	14
Total square feet of meeting space	15,000
Maximum Meeting Capacity	750
Business Center	Yes
Hi-Speed Internet	Yes
Voice Messaging	Yes
On-Site AV	Yes
Handicap Accessible	Yes
Airport Shuttle	Yes (charge)
Parking	Yes
Restaurant/Bar	Yes
Swimming Pool/Spa	Yes
Workout Facility	Yes
Smoke-Free Rooms	Yes
Laundry/Valet	Yes
Room Service	Yes

Hotel Overview

Located in the heart of the state capital’s downtown—complete with great entertainment, museums, attractions and dining—the Raleigh Marriott City Center hotel has well-appointed guest rooms featuring Marriott’s luxury bedding. The hotel connects to the 500,000-square-foot Raleigh Convention Center, an elegant and functional space, featuring a spectacular exhibit hall. Within the Marriott, there is 15,000 square feet of multi-functional, flexible event space.

Guest room amenities

- Individual temperature control
- High-speed wireless Internet service
- Spacious work desk with comfortable chair
- 37-inch LCD television
- Premium TV channels, pay-per-view movies
- Hair dryer, iron/ironing board
- Coffee/tea maker
- Weekday newspaper
- Express check-in and check-out available
- Jack Pack, connectivity solution
- In-room safes

Hotel amenities and services

- Posta Tuscan Grille serving breakfast, lunch and dinner
- Bar Posta, lounge adjoining the restaurant
- Starbucks store
- Full-service business center with fax, copier, Internet, overnight shipping services
- High-speed wireless Internet service throughout the hotel
- Indoor swimming pool and hot tub
- 1,200-square-foot fitness center
- Concierge services
- Safety deposit boxes
- Room service
- Valet or self-park
- Full-service gift shop



RALEIGH MARRIOTT CITY CENTER

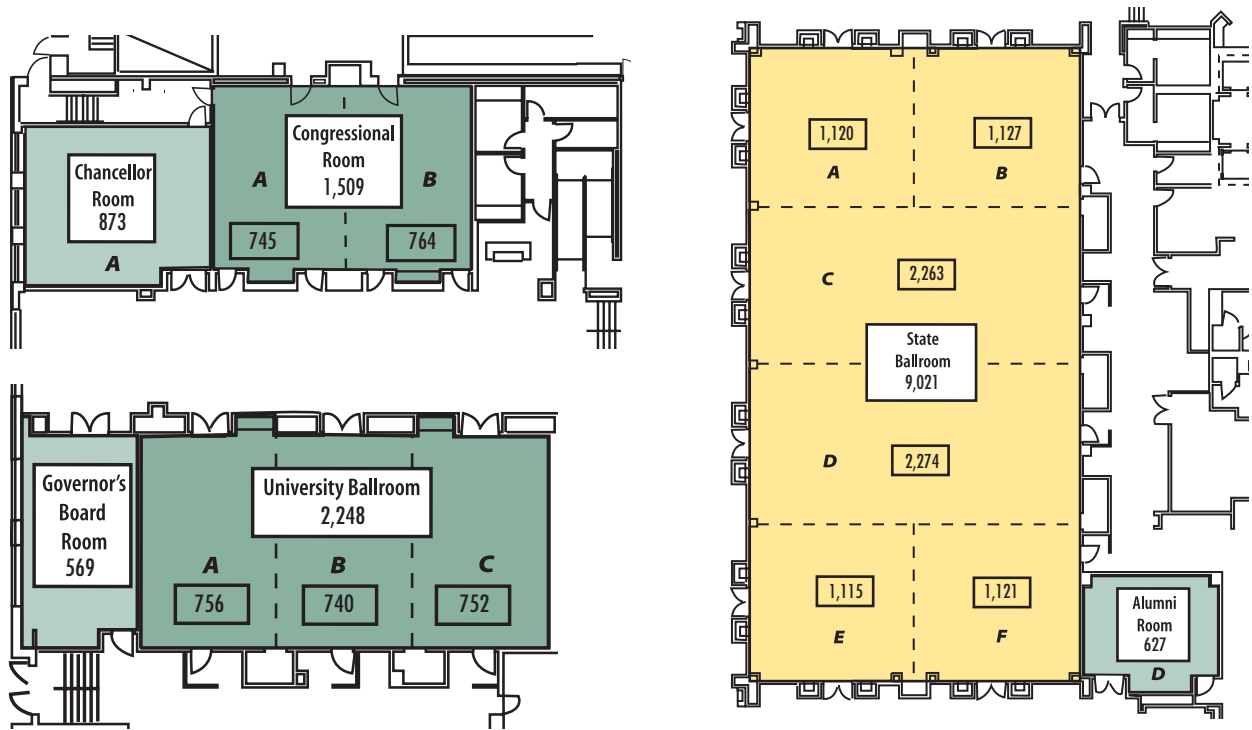

Room	Dimensions			Capacities				
	SQ. FT.	SIZE	CEILING	THEATRE	CLASSROOM	BANQUET	CONFERENCE	RECEPTION
State Ballroom	9,021	62'x132'	16'	1,036	648	630	N/A	800
State A	1,120	33'x34'	16'	140	72	70	33	100
State B	1,127	33'x34'	16'	140	72	70	33	100
State C	2,263	33'x69'	16'	280	144	150	57	200
State D	2,274	33'x69'	16'	280	144	150	57	200
State E	1,115	33'x34'	16'	140	72	70	33	100
State F	1,121	33'x34'	16'	140	72	70	33	100
University Ballroom	2,248	34'x66'	14'	224	120	180	50	200
University A	756	34'x22'	14'	90	36	60	24	75
University B	740	34'x22'	14'	90	36	60	24	75
University C	752	34'x22'	14'	90	36	60	24	75
Chancellor Room	873	33'x28'	14'	100	50	70	24	85
Congressional	1,509	64'x24'	14'	180	75	110	36	150
Congressional A	745	32'x23'	14'	90	36	60	24	75
Congressional B	764	32'x23'	14'	90	36	60	24	75
Alumni Room	627	21'x29'	14'	60	24	40	18	45
Governor's Board Room	569	18'x31'	10'	N/A	N/A	N/A	16	N/A
Esplanade	2,700	23'x100'	16'	N/A	N/A	N/A	N/A	200



April 27, 2017

Mr. Sean Haynes
IEEE SoutheastCon 2020
2407 Hilwood Place
Charlottesville, VA 22901

Dear Karen:

We are excited about the opportunity to host the IEEE SoutheastCon in the spring of 2020. With Raleigh's southern hospitality and hip city vibe, choosing the Raleigh Marriott City Center will be the perfect mix for the attendees to concentrate on the SAS campus during the day and explore downtown Raleigh in the evenings. After reviewing availability, we are pleased to offer on a first option basis for the preferred dates of May 18 -20, 2018.

A few quick highlights about the [Raleigh Marriott City Center](#), located in the heart of downtown.

- 400 guest rooms with 15,000 square feet of refreshed meeting space all on one level
- Full-service Starbucks in lobby
- Rye Bar and Southern Bar – Hotel Restaurant which offers a local refined take on Southern cuisine
- Within walking distance of more than 60 restaurants
- Within walking distance of a number of museums and local shopping options
- Approximately 15 miles from Raleigh/Durham International airport with more than 40 non-stops and over 400 flights daily

Please feel free to contact me directly at (919) 747-5449 or via email at melissa.haycock@MarriottRaleigh.com should you have any questions about the offer, the hotel or destination. We'd be delighted to have you visit and experience the city firsthand. Thank you again for your consideration and I hope to work with you to execute a successful event.

Kind regards,

Melissa Haycock
Senior Sales Manager



A Proposal Especially Prepared for:

IEEE Southeast Con
March 11- 16, 2018

GUEST ROOM BLOCK

The hotel is pleased to offer a group rate per room, per night for deluxe guest room. Rates are exclusive of tax which is currently 13.25% and net, non-commissionable.

Date	Day	Standard	Total Rooms
03/11/2020	Wed	25	25
03/12/2020	Thu	200	200
03/13/2020	Fri	225	225
03/14/2020	Sat	225	225
03/15/2020	Sun	10	10

Raleigh Marriott City Center is pleased to offer the following group room rates:

Start Date	End Date	Room Type	Single
03/11/2020	03/15/2020	Standard	\$189.00

REBATE

Room rate includes a \$19 per room, per night rebate. Rebate will be paid directly to the Raleigh Convention Center to cover the cost Room Rental. If the rebate amount is less than the contracted Room Rental amount, the Group is responsible for paying the difference to cover the full cost.

EVENT AGENDA

All meeting space outlined on the RFP is available at this time; however, please note, the meeting space is not being held. Please let us know if you would like to have the space placed on a tentative hold.

The Hotel will provide the Group with function space in accordance with the schedule of events described below. The Hotel reserves the right to make reasonable substitutions in meeting rooms.

Date	Day	Start Time	End Time	Function Type	Setup	# People	Proposed Room
03/14/2020	Sat	8:00 AM	5:00 PM	Meeting	Schoolroom	25	Congressional A
03/14/2020	Sat	8:00 AM	5:00 PM	Meeting	Schoolroom	25	Congressional B

All meeting room, food and beverage, and related services are subject to applicable taxes (currently 8.25%) and service charge (currently 25%) in effect on the date(s) of the event.

FACILITY SERVICE FEES

Based on the meeting requirements, meeting room fees will be waived with a food and beverage minimum spend of \$1,500.00 exclusive of tax and service charge or the difference will be charged as room rental to the master account.

TECHNICAL ALLOCATION FEE

The Hotel is proud to offer the finest audio-visual equipment, services and support to our guests. Outside audio visual companies will be subject to a \$500.00 technical allocation per day, exclusive of tax and service charge.

CONCESSIONS

We are pleased to offer the following concessions based on 80% pick up of guest room block:

- One (1) complimentary upgrade to Governors Suite
- Up to two (2) staff rooms per night at a reduced rate
- One complimentary room for every 50 occupied on a cumulative basis, to be assigned and utilized during the even
- Complimentary high speed internet in all guest rooms, valued at \$11.95 per day
- Group rate available three days prior and three days post, based on availability
- Discounted valet parking for attendees - 20% off published rate
- Five (5) complimentary valet parking passes

CATERING MENU LINK: [2017 Catering Menus](#)

AV GUIDE LINK: [AV Guide](#)

DINING

Rye Bar and Southern Kitchen is open daily for breakfast, lunch and dinner. The hotel's in-house restaurant features a refined take on traditional Southern cuisine, inspired by the abundance of quality ingredients from North Carolina and surrounding farmers. Executive Chef, Michael Rigot, handpicks local and regional craft beers, has created an innovative cocktail menu and crafted a well-appointed wine list. Private dining is also available in the Private Dining Room.

Visit our website for current menus www.ryeraleigh.com

Explore around town: There are more than 60 restaurants, mostly local, within walking distance of the hotel.

Need Coffee? Starbucks Coffee is located in the hotel lobby. Open daily from 7am to 6pm.



PARKING

The Raleigh Marriott City Center is adjacent to a 900 space city owned parking garage managed by McLaurin Parking, which serves the convention center and hotel guests alike. Current pricing below are subject to change.

- Valet, Overnight, \$30 per night & Day Event, \$18 per day
- Self-parking Day Rate, \$3 per hour with a maximum of \$12 per day/ Overnight

AIRPORT TRANSPORTATION

Raleigh Durham International Airport (RDU) is 15 miles from downtown. Raleigh—just a 20-minute drive. RDU Taxi, Inc. provides service to and from RDU. Reservations and on-demand service are available.

HAVE YOU SEEN WHAT'S ON THE INSIDE? [Virtually Tour the Raleigh Marriott City Center](#)

MARRIOTT REWARDS POINTS

Marriott Rewards® offers exclusive membership privileges when you travel, as well as your choice of frequent flyer miles in your preferred airline program or points toward free vacations for every dollar you spend at over 2,400 hotels in the Marriott family.

www.marriott.com

PROPOSAL

Thank you again for your consideration. Please note, we are not currently holding guest rooms or meeting space but would be happy to do so for your preferred dates upon request. Our offer is valid until October 31, 2017. Should another group express interest for the same dates, we will contact you for your decision and permit 48 hours to either agree to contract terms or release space.

Submitted by:

Melissa Haycock, Sales Manager

Raleigh Marriott City Center

500 Fayetteville Street

Raleigh, NC 27601

www.marriott.com/rdumc

Direct: (919) 747-5449

Fax: (919) 833-8912

Melissa.haycock@marriottraleigh.com

Residence Inn[®] Marriott

RALEIGH DOWNTOWN
616 S. Salisbury Street
Raleigh, NC 27601

Group Proposal

DATE: May 1, 2017

Thank you for your interest in the new Residence Inn Raleigh Downtown. This document serves as a proposal for arrangements for the IEEE SoutheastCon 2020 (herein referred to as the ORGANIZATION) by the Residence Inn Raleigh Downtown Hotel (herein referred to as the HOTEL).

HOTEL INTRODUCTION

Opening late spring 2017, Residence Inn by Marriott Raleigh Downtown is located in the heart of Downtown on South Salisbury Street, at the Fayetteville Street District. The Residence Inn Raleigh Downtown is a 175 room, all-suite hotel that includes all essential services for your hotel stay, long or short. We are steps away from Raleigh Convention Center and the Red Hat Amphitheater and a variety of live music venues are within blocks of the hotel; Raleigh's burgeoning culinary and craft brewery scene is at your doorstep. Our suites include fully equipped kitchens with cookware and utensils, glassware and appliances so you don't have to miss a beat while away from home! Start your day at the oversized state-of-the-art fitness facility with prominent views of South Salisbury Street and complimentary full hot breakfast; stay productive at the hotel business center or at the work desk at your suite, with complimentary Wi-Fi; unwind after your day on the 10th floor rooftop Bar & Lounge, dine at our 2nd floor Overlook Brasserie or the two on-site street level restaurants.

We look forward to welcoming you to Raleigh's newest downtown hotel, the place to be!



GROUP INFORMATION

Event Name: IEEE SoutheastCon 2020
Proposed event dates: 03/11/2020 - 03/16/2020
Contact Info: Sean Haynes
IEEE Region 3 Section Congress Coordinator 2020
2407 Hilwood Place
Charlottesville, VA 22901
Contact Phone/ Email: (434)933-2611/ s.a.haynes@ieee.org

GROUP ROOM RATES

Based upon Organization’s overnight room needs, Hotel confirms the following group rates (Excludes taxes):

- Studio King Suites (includes pullout sofa bed) \$179.00
- Studio Queen-Queen Suites (includes pullout sofa bed) \$189.00

Hotel room rates are subject to applicable state and local taxes (currently 13.25%).

GUEST ROOM BLOCK

The Hotel confirms that it will provide up to 185 room nights in the pattern set forth below:

IEEE SoutheastCon 2020	Wednesday 3/11/2020	Thursday 3/12/2020	Friday 3/13/2020	Saturday 3/14/2020	Sunday 3/15/2020	Monday 3/16/2020
Studio King Suites	15	30	30	30	7	Checkout
Studio Queen-Queen Suites	10	20	20	20	3	Checkout
All Suites Run of House Room Type	25	50	50	50	10	Checkout

- The group room rates listed above includes a rebate of \$19 on all utilized room nights at the contracted group room rate above.
- Group rates valid two (2) days before and after group block dates based on availability.
- Group rate will be subject to a 21 days prior cut-off date and after that time the group rate will be honored based on availability.
- Complimentary full American breakfast served daily (\$14.95 value)
- Complimentary standard Wi-Fi in all suites and public areas

COMMISSION/REBATES (Rooms Commissionable)

The group room rates listed above include a commission or rebate of [ENTRY]% OR \$[ENTRY] on all utilized room nights at the contracted group room rate above, payable to «travel_agent» at the time final payment for the Master Account is received by the Hotel. Such commission or rebate will only be payable to «travel_agent» if a valid IATA/ARC number is provided to hotel prior to Organization’s arrival. Hotel reserves the right to deduct from any future commission or rebate payable to «travel_agent» for other events, any commission or rebate paid in connection with this Event, if the Master Bill is not paid in full within three (3) months after the conclusion of the Event.

Residence
Inn[®]
Marriott

RALEIGH DOWNTOWN

Thank you again for the opportunity to earn your business and bid on the IEEE SoutheastCon 2020. Please feel free to let us know if you have any questions or would like to discuss further. In the meantime, here is a [link](#) to take a closer look at the new Residence Inn Raleigh Downtown! We are truly excited at the chance for Raleigh to host this show and we look forward to hearing from you soon!

Sincerely,

Emily Winfrey

Emily Winfrey, Director of Sales
(919) 410-3396
ewinfrey@shglttd.com

Where to Meet



Sheraton Raleigh Hotel

421 S. Salisbury St.
Raleigh, North Carolina 27601

Telephone: 919.834.9900
Fax: 919.833.1217
Web: Sheratonraleigh.com

Vital statistics

# of Sleeping Rooms	353
# of Suites	6
# of Meeting Rooms	14
Total Square Feet of Meeting Space	20,000
Maximum Meeting Capacity	450
Business Center	Yes
Hi-Speed Internet	Yes
Voice Messaging	Yes
On-Site AV	Yes
Handicap Accessible	Yes
Airport Shuttle	No
Parking	Yes (charge)
Restaurant/Bar	Yes
Swimming Pool/Spa	Yes
Workout Facility	Yes
Smoke-Free Rooms	Yes
Laundry/Valet	Yes
Room Service	Yes

Hotel Overview

Step inside the warm, maple-trimmed walls of the newly-renovated Sheraton Raleigh Hotel, and your spirits will rise as high as our sun-filled atrium. Located in the heart of downtown Raleigh, we have 353 of the most luxurious guest rooms in the city, 20,000 square feet of meeting and banquet space and an experienced, friendly, award-winning staff waiting to make every conference a complete success. Located one block from the Duke Energy Center for the Performing Arts, adjacent to the Raleigh Convention Center, we are right in the middle of all the excitement that is downtown Raleigh. The Sheraton Raleigh Hotel is in walking distance to over 60 restaurants and nightlife venues, the State Capitol, many museums and shopping with an upscale local flavor.

Discover meetings worth attending and weddings worth remembering. When we host your event, we promise to surpass your expectations.



Sheraton
Raleigh
HOTEL

SHERATON RALEIGH HOTEL

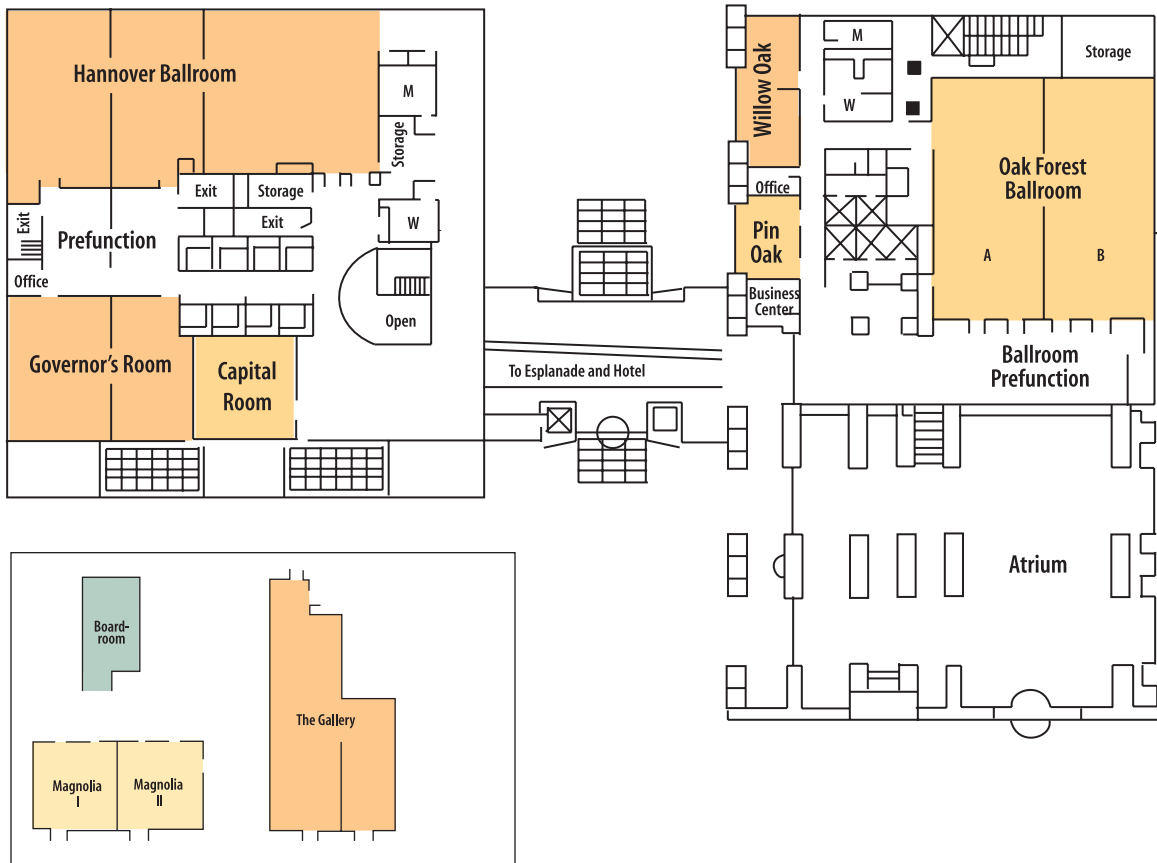

Room	Dimensions			Capacities				
	SQ. FT.	SIZE	CEILING	THEATRE	CLASSROOM	BANQUET	CONFERENCE	RECEPTION
Hannover Ballroom	5,080	47'x108'	10.5'	350	225	400	N/A	500
Hannover Ballroom Section I	2,392	46'x52'	10.5'	200	120	150	N/A	240
Hannover Ballroom Section II	1,344	48'x28'	10.5'	120	65	80	N/A	130
Hannover Ballroom Section III	1,344	48'x28'	10.5'	120	65	80	N/A	130
Oak Forest Ballroom A & B	4,544	64'x72'	16'	600	270	400	N/A	465
Oak Forest Ballroom A	2,272	32'x72'	16'	300	135	210	N/A	230
Oak Forest Ballroom B	2,302	32'x72'	16'	300	135	210	N/A	230
Governor's Room Section I & II	2,183	42'x52'	10.5'	200	75	130	N/A	225
Governor's Room Section I	1,175	42'x28'	10.5'	120	50	60	N/A	120
Governor's Room Section II	1,008	42'x24'	10.5'	110	35	50	N/A	105
Capital Room	959	30'x32'	10.5'	75	10	50	20	100
Magnolia I	675	26'x26'	8.5'	50	24	40	15	65
Magnolia II	675	26'x26'	8.5'	50	24	40	15	65
Executive Boardroom	500	20'x25'	7.7'	N/A	N/A	66	10	N/A
The Gallery Restaurant	2,380	68'x35'	38'	N/A	N/A	110	N/A	150
Willow Oak	741	19'x39'	13.3'	75	45	60	15	75
Pin Oak Room	475	19'x25'	13.3'	40	18	40	10	45
Esplanade	2,700	23'x100'	16'	N/A	N/A	N/A	N/A	200
The Atrium	1,650	38'x64'	38'	N/A	N/A	N/A	N/A	150

Sean Haynes
IEEE
2407 Hillwood Pl
Charlottesville, VA 22901

Thursday, 27 April 2017

IEEE SoutheastCon 2020

Dear Mr. Haynes,

Thank you for your interest in placing your guests for IEEE SoutheastCon 2020 with Starwood Hotels & Resorts. I am very pleased to introduce myself as your representative for Sheraton Raleigh Hotel. My goal is to provide seamless and efficient communication to find the best fit and value for your program. Detailed below is information on how your program would fit at our property. I look forward to speaking with you soon!

1st Option

We are delighted to be able to offer you 1st option availability and are holding the space for you until Friday, 29 December 2017, after which time the space is will be released if not confirmed.

Sheraton Raleigh Hotel The following information should be helpful in answering any questions you may have concerning the hotel.

Located in the heart of downtown Raleigh, our hotel offers many options of things to do. With over 80 restaurants, bars, nightlife, an amphitheater, performing arts center, music hall, art galleries, museums, IMAX movie theatre and more, all with in a 3 block radius. The possibilities for your meeting attendees are endless when in downtown Raleigh!



The Hotel is designed with 353 luxurious guestrooms. We also have 2

Presidential Suites, 4 Junior Suites, and 13 handicapped accessible rooms, all smoke-free. Your night's sleep will never be the same! We have Sheraton Sweet Sleeper Beds in all of our guestrooms.

We are excited to announce a multi-million dollar room renovation was completed in November 2016!



The 16th & 17th floors are designated as the **Club Level**. The 17th Floor is complete with a private lounge service complimentary continental breakfast, evening hors d'oeuvres and cocktails.

Our newly renovated banquet and conference facility features an exquisitely decorated 4500 square foot ballroom, which will seat 400 people theater style. The total meeting facility consists of over 18,000 sq. ft. with a total of 14 conference rooms.



Hidden just off the main lobby is our exercise and fitness facility. You will find a relaxing atmosphere with state of the art fitness equipment and indoor pool.

Our restaurant, **Jimmy V's Osteria & Bar** is a unique and modern restaurant that gives you a taste of Italian favorites. Jim Valvano's passion and commitment to excellence is the inspiration ingrained in the restaurant's culture. As a commitment to connect with our community, we are donating 2.5% of its revenue to support **The V Foundation** in cutting edge research for cancer treatment. We

invite you to experience a meal in our restaurant and be a part of Jimmy V's commitment to finding a **cure!**



Additional Information

We offer Valet Parking or Self-Parking which is conveniently located across the street from our main entrance. We can arrange for shuttle by employing a third-party vendor.

RDU International Airport is located 15 miles away. Average taxi fare is \$35-\$40 one way. UBER/LYFT rates are generally lower. <http://www.rdu.com/>

We are a TAG Approved property. We take great pride in our inclusive atmosphere where ALL are welcome. Please visit <http://www.tagapproved.com/> for additional information.

Based upon your needs, as we currently understand them to be, I would like to offer the following:

Schedule of Events

All of the meeting space is reserved at the Raleigh Convention Center conveniently located directly across the street.

Accommodations

Any changes of pattern or quantities are subject to availability and may incur a rate change.

Attendees Room Block

	Wed, Mar 11, 2020	Thu, Mar 12, 2020	Fri, Mar 13, 2020	Sat, Mar 14, 2020	Sun, Mar 15, 2020	Total
Attendees Room Block Total	25	200	225	225	10	685

Total Number of Guestrooms: 685

Accommodation Rates

Kindly note all rates are exclusive of Breakfast and Tax unless otherwise stated. Rates are valid for the services, dates and numbers offered above.

Attendees Room Block

Rooms	Single Rate	Double Rate	Triple Rate	Quad Rate
Run of House	\$179	\$179	\$189	\$199

Schedule of Events

Kindly note all rates are exclusive of Tax unless otherwise stated.

Date	Function Description	Start - End Time	Function Space	Setup	# PPL	Room Rental
Sat, 14-Mar-2020	Concurrent Session	8:00AM - 5:00PM	Magnolia I	Classroom Style	25	
Sat, 14-Mar-2020	Concurrent Session	8:00AM - 5:00PM	Magnolia II	Classroom Style	25	
Total						

Rental Minimum: Waived

Banquet Online menus are available by clicking the following link:

[Sheraton Raleigh Hotel Banquet Menus](#)

Floor plans and pictures of meeting space are available by clicking the following link:

[Sheraton Raleigh Hotel Meeting Space](#)

Concessions

- \$19 rebate included in rate to offset costs at RCC
- Additional concessions negotiable

SPG Pro

You're in the people business, and in this line of work, business is always personal. We don't just look at what you do for a living; we also look at what you do for life. That's why we created SPG Pro, a loyalty offering that rewards you personally for the things you do professionally.

- Great Points. Earn 1 Starpoint for every US\$3 you book for meetings to a max of 20,000 Starpoints per event. Earning gets richer when you reach elite status.
- Go elite. Earn 1 eligible night toward elite status for every 20 group room nights to a maximum of 20 eligible nights per event. Elite status starts at just 25 eligible nights per year.
- You've earned it. Redeem Starpoints for whatever you want – like a free night at The St. Regis New York or VIP treatment at the US Open.

[Join Now](#)

Looking for any other destinations?

If you are looking for meeting space and/or group bedrooms at any other destination, we would be delighted to reach out to one of our over 1,000 properties around the world.

Please click on the link to browse our property directory: [Starwood Hotels & Resorts](#)

I hope that you have found the outlined proposal to be not only informative but one that fits the needs of your organization. I sincerely feel that the Sheraton Raleigh Hotel will provide you with the service, dedication and attention to every detail that you desire and deserve!

Kind Regards,



Maite Vigil
Sales Manager
Maite.vigil@sheratonraleigh.com
919-256-1406

[Sheraton Raleigh Hotel Digital Brochure](#)

Services of the Greater Raleigh Convention and Visitors Bureau



Think Raleigh!

Dear Meeting Professional:

THE ROLE OF GRCVB (after the sales process) includes assisting arriving groups with services that involve the destination (in other words, services outside the event venue). Our services for groups greater than 200 attendees include:

- **Pre-convention planning assistance and advice on:**
 - Special events venues (unique meeting sites)
 - Visitor attractions and things to do
 - Guided tour companies
 - visitRaleigh.com for gathering information about the area, as well as finding the vendor, attraction or service that best meets your needs
- **Communications and public relations assistance:**
 - Local, statewide and regional lists are available through our Communications Department.
 - A public relations kit is available offering you tips on the creation of press releases and media alerts.
- **Marketing and attendance promotion:**
 - Our Marketing Department can assist you with pre-promotion and marketing efforts including use of our image library, brand-wording materials and A/V presentations.
- **Red Carpet Welcome Program for groups (this is a combination of communications designed to help our business community be more aware of your group, thus providing a better level of hospitality):**
 - Welcome banners offered for key venues and host hotels
 - *Convention Alert* to communicate specific details about your group to local businesses, downtown Raleigh Ambassadors, Raleigh police and other businesses in the direct area of your convention location
 - Joint welcome letter from mayor/city, the county and GRCVB (per group's need)
 - Coordinated pre-convention meeting with Raleigh Convention Center, host hotels and GRCVB (per group's need)
 - On-site welcome booth stocked with visitor information and staffed with GRCVB staff representatives and Raleigh Tourism Ambassadors (materials include *Official Visitors Guide to Raleigh, Cary and Wake County*, Hanging Around Downtown map, SmartCard deals information, etc.)
 - Assistance with training and preparation of your volunteer registration committee
- **Post-event evaluation sent to planner to assess how we've done and how we might improve in the future**



For more information, contact the staff of the [Greater Raleigh Convention and Visitors Bureau](#):

Julie Brakenbury, Director of Convention Services
421 Fayetteville St., Ste. 1505 ★ Raleigh, NC 27601-2995
Direct Line: 919.645.2661 ★ 800.849.8499 ★ 919.831.2887 FAX ★ www.visitRaleigh.com
jbrakenbury@visitRaleigh.com



Tammy Jeffries, Assistant Director of Convention Services
421 Fayetteville St., Ste. 1505 ★ Raleigh, NC 27601-2995
Direct Line: 919.645.2674 ★ 800.849.8499 ★ 919.831.2887 FAX ★ www.visitRaleigh.com
tjeffries@visitRaleigh.com

How to Get Here



How to Get Here



Interstate highways and scores of transportation services make getting to the area easy. You can come by plane, train, bus or automobile. In fact, more than half of the United States' population lives within a day's drive or a two-hour flight of Raleigh.



If arriving by air, RDU International Airport has consistently been judged to be the favorite airport in North America among business travelers, as well as consistently ranking as the most efficient small/medium airport in North America. RDU is also centrally located, making it a 15-mile drive to downtown Raleigh.

Choosing to drive here is just as convenient. Located centrally on the East Coast, Raleigh is halfway between Florida and New York. I-40, which connects the East and West Coasts, runs through Raleigh. The area's first-rate system of state highways, the I-540 Outer Loop and the I-440 Beltline provide easy access to the city. I-95 and I-85 pass within 25 miles of the city, with I-95 connected to Raleigh by I-495.

Regardless of how you choose to arrive in Raleigh, getting around once you're here couldn't be easier. Downtown Raleigh is a walkable place with restaurants and shopping at your fingertips, or take a readily available R-LINE downtown circulator bus, rickshaw, cab, shuttle or private car to the destination of your choice.

Travel facts

Location Centrally located on the East Coast, halfway between New York and Florida.

RDU

- Over 400 daily arrivals and departures are offered at RDU International Airport
- Eight major airlines
- 9.1 million passengers annually

Non-stop flights from nearly 40 locations to RDU.

RDU's \$600 million Terminal 2 features an expanded airline ticketing area and security checkpoint, 25 boarding gates, restaurants and shopping.

The \$68 million modernization of Terminal 1 is now completed with floor-to-ceiling windows, power outlets at the gates and new shops and restaurants. Terminal 1 is home to Southwest Airlines.

RDU is 15 miles from downtown Raleigh—just a 20-minute drive.

Transportation

Raleigh is accessible by Amtrak train and Greyhound bus service.

An array of ground transportation services is available at RDU. See more information on the Travel by Air page at visitRaleigh.com.

RDU International Airport

Terminal 1

Ticketing and bag claim level

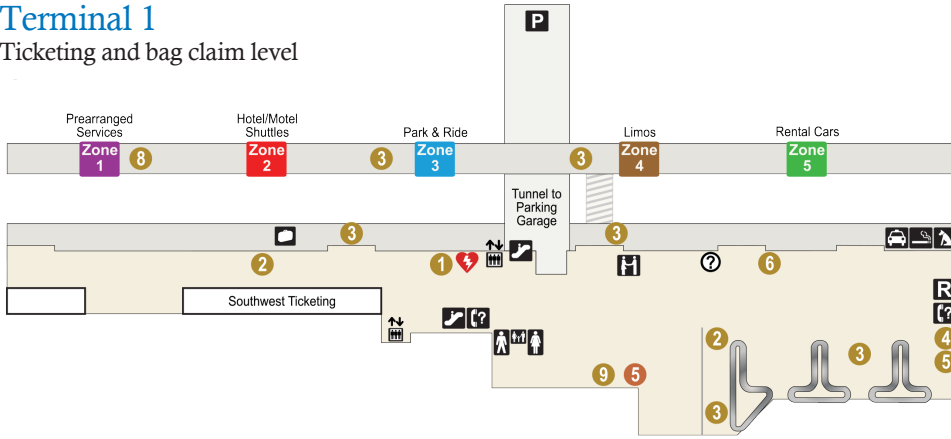

Symbols Legend

Automated External Defibrillator	Reservations (Hotel/Rental Car)
Courtesy Phones	Restrooms
Elevators	Security Checkpoint
Escalators	Service Animal Relief Area
Information	Skycap
Meet and Greet Area	Smoking Area
Parking	Taxi Dispatch

Services and Amenities

1 ATMs	6 Special Events Desk
2 Newspaper Vending	7 Superior Shine
3 Smarte Carte	8 Triangle Transit
4 Snack/Drink Vending	9 24-Hour Flower
5 Southwest Bag Service	

Retail

1 Flight Stop
2 Marshall-Roussio
3 Ruby blue
4 Techshowcase

Food and Beverages

1 ACC American Café
2 Char-Grill
3 La Tapenade Mediterranean Café
4 Salsaritas Fresh Cantina
5 Starbucks

Concourse level

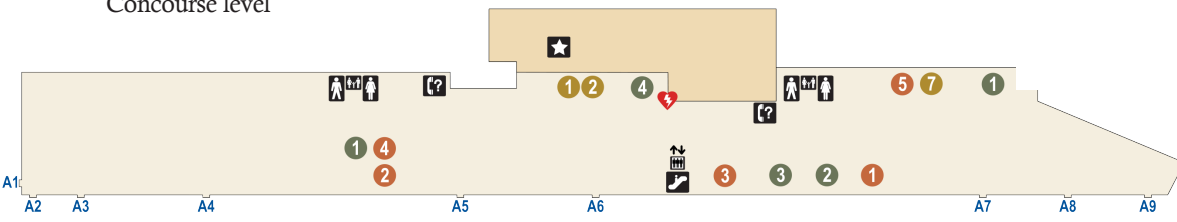

Terminal 2

Ticketing and concourse level

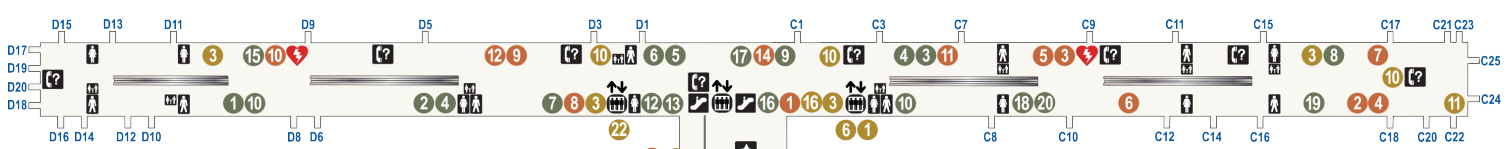

Retail

- 2nd Edition Book Sellers
- 3FLOZ
- Benefit
- Best Buy Express
- Brighton
- Brooks Brothers
- CNBC News
- EJE Travel Retail (Duty-Free/Duty-Paid)
- Hudson Booksellers
- Hudson News/AeroMart
- Hudson News/Discover
- Kids/Works
- Life is good
- OTC Drugs & More
- PGA Tour Shop
- Shaw News
- Taxco Sterling
- Techshowcase
- University Kids/ University Marketplace
- XpresSpa

Food and Beverages

- 42nd St. Oyster Bar
- A&W All American Food
- Brookwood Farms
- Bruegger's Bagels
- California Pizza Kitchen
- Camden food co.
- Carolina Ale House
- Carolina Vintages
- Five Guys Burgers and Fries
- Flavours
- Gordon Biersch
- Jason's Deli
- Panopolis
- Starbucks

Services and Amenities

- Admirals Club
- American American Eagle Bag Service
- ATMs
- Customs and Border Protection
- Delta Bag Service
- Delta Sky Club
- Heritage Room
- JetBlue Bag Service
- Meditation Room
- Newspaper Vending
- Pay E-mail
- Prepaid Phone Cards
- Smarte Carte
- Snack/Drink Vending
- Special Events Desk
- Superior Shine
- Travellex Worldwide Money
- Triangle Transit
- 24 Hour Flower
- United, Air Canada Bag Service
- US Airways Bag Service
- US Airways Club
- USO of N.C. Center

Gate Information

C1 Delta	D1 United
C3 Delta	D3 United
C7 Delta	D5 United
C8 JetBlue	D6 United
C9 Delta	D9 United
C10 JetBlue	D10 US Airways
C11 Delta	D11 US Airways
C12 Delta	D12 US Airways
C14 Delta	D13 US Airways
C15 Delta	D14 Air Canada
C16 Delta	
C17 American	
C18 American	
C21 American	
C23 American	
C25 American	

Bag claim

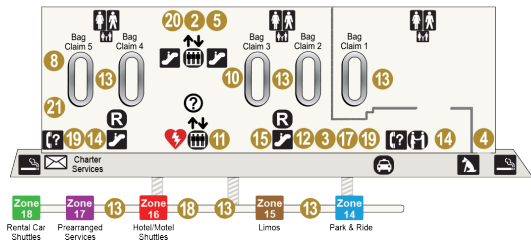

Symbols Legend

Automated External Defibrillator	Reservations (Hotel/Rental Car)
Courtesy Phones	Restrooms - Female
Elevators	Restrooms - Male
Escalators	Restrooms - Family
Information	Security Checkpoint
Meet and Greet Area	Service Animal Relief Area
Post Office Box	Smoking Area
Taxi Dispatch	

Flying and Ground Transportation

RDU International Airport

RDU has more than 400 daily arrivals and departures, reaching nearly 40 destinations nonstop. With eight major airlines to serve more than nine million passengers each year, RDU can get you where you want to go when it's time to return home. For more information about the airport, visit the RDU website at www.rdu.com.

Locations with Non-Stop Service to RDU

Atlanta
 Baltimore/Washington
 Boston
 Charlotte
 Chicago Midway
 Chicago O'Hare
 Cincinnati
 Cleveland
 Columbus
 Dallas-Ft. Worth
 Dallas Love Field
 Denver
 Detroit
 Fort Lauderdale
 Hartford
 Houston-Bush
 Houston-Hobby
 Indianapolis
 Las Vegas
 Los Angeles
 Miami
 Minneapolis
 Nashville
 Newark
 New York, Kennedy
 New York, La Guardia
 Orlando International
 Orlando Sanford
 Philadelphia
 Phoenix
 Pittsburgh
 Punta Gorda
 Salt Lake City
 San Francisco
 Seattle
 St. Louis
 St. Pete Clearwater
 Tampa
 Trenton-Mercer County
 Washington Dulles
 Washington Reagan

International Flights

Cancun, Mexico
 London, U.K. Heathrow
 Paris, Charles de Gaulle
 Toronto, Canada



Ground Transportation at RDU

RDU International Airport offers passengers a variety of transportation options, ranging from taxi and limousine services to rental cars and transit buses, as well as connections to local bus and train stations.

Rental Cars

Nine rental car agencies are located at RDU and are a quick shuttle bus ride from the terminals. Shuttles run approximately every 15 minutes and stop on each terminal curb near the baggage claim areas. Look for the green bus shelters marked Rental Car.

Taxis

RDU Taxi, Inc. provides service to and from RDU. To schedule a taxi, please call 919.840.7277 or make a reservation at rdutaxiinc.com. Reservations and on-demand service are available. Terminal 1's taxi dispatch booth is located on the curb near baggage claim. The Terminal 2 dispatch booth is located on the curb on the terminal's lower level.

Typical charges

- \$3.50 initial charge (includes \$1 fuel fee)
- \$.65 for each additional 1/3 or fraction-of-a-mile thereafter
- \$.50 for each piece of luggage over three pieces-per-person
- \$5.45 for the first mile
- \$1.95 each additional mile



The average trip between RDU International Airport and downtown Raleigh costs approximately \$35.

The City of Raleigh's taxi certification program alerts Raleigh visitors that taxis have been inspected and fit all local legal requirements. The symbol on the left indicates a City of Raleigh-approved taxi.

Transit Buses

Passengers can take GoTriangle route 100 to downtown Raleigh or the Regional Transit Center. Service is offered at least every hour from 6:30am to 10:25pm, Mon. through Sat. Fares are \$2.25 per trip; regional day passes are available for \$4.50 and can be purchased on the bus. Look for the GoTriangle signage.

Shared Ride Services

AA&D Transportation • 919.877.9599
 Charlene's Safe Ride • 919.309.7233
 Sky Shuttle Inc. • 919.599.8100
 Skylink Shuttle • 919.233-3952, 855.759.8267

Driving

North Carolina

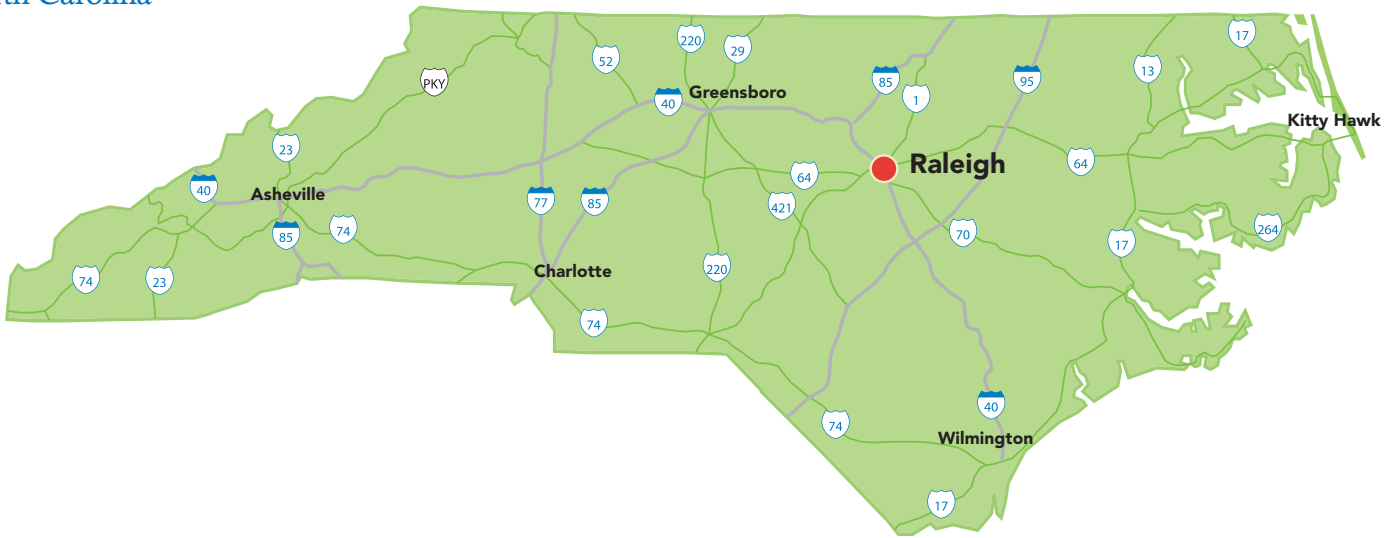

Primary Highways

A superb network of interstates and highways makes getting to Raleigh easy from any direction.

- I-40, one of the nation’s primary east-west interstates, passes through Raleigh.
- Additionally, I-95 (north-south) and I-85 (north-south) pass within 25 miles of Raleigh.

Other major highways serving Raleigh include:

- U.S. Highways 1 and 401 (north-south)
- U.S. Highways 64 and 70 (east-west)
- N.C. Highways 50 (north-south), 55 (east-west) and 54 (east-west)
- I-440 Loop (Beltline)
- I-495
- I-540 Outer Loop

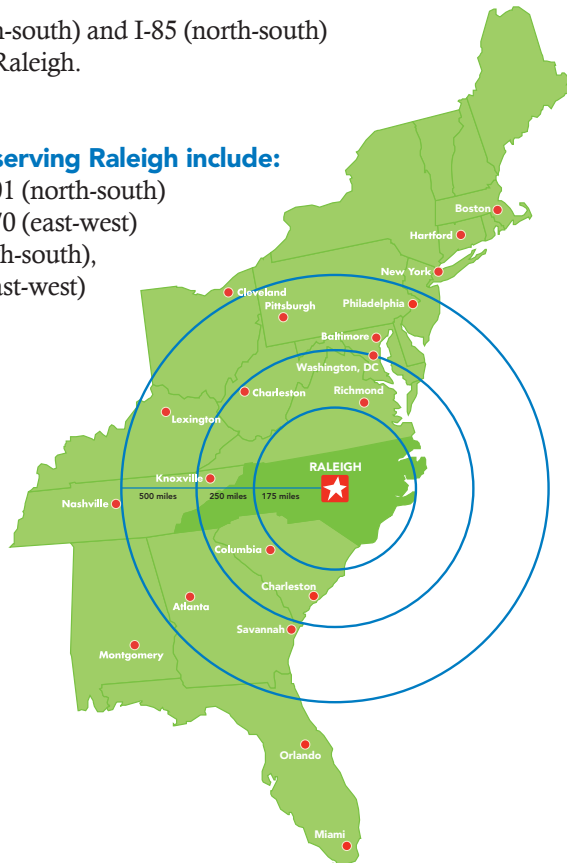

To Raleigh...

from other North Carolina cities

CITY	DISTANCE (MI.)	CITY	DISTANCE (MI.)
Asheville	241	Jacksonville	116
Boone	189	Nags Head	197
Chapel Hill	28	New Bern	112
Charlotte	143	Rocky Mount	53
Durham	23	Southern Pines/ Pinehurst	71
Fayetteville	59	Wilmington	123
Greensboro	78	Winston-Salem	104
Greenville	85		
High Point	93		

To Raleigh...

from major U.S. cities

CITY	DISTANCE (MI.)
Atlanta, Ga.	424
Baltimore, Md.	290
Birmingham, Ala.	514
Charleston, S.C.	245
Charleston, W.Va.	319
Cincinnati, Ohio	514
Cleveland, Ohio	563
Columbia, S.C.	200
Columbus, Ohio	483
Hartford, Conn.	590
Jacksonville, Fla.	447
Louisville, Ky.	546
Nashville, Tenn.	515
New York, N.Y.	489
Norfolk, Va.	166
Orlando, Fla.	588
Philadelphia, Pa.	383
Pittsburgh, Pa.	445
Richmond, Va.	147
Washington, D.C.	251

Eastern United States

Resources for travelers

Official Visitor Information

Greater Raleigh Visitor Information Center

500 Fayetteville St., Raleigh 27601
(Conveniently located between the Raleigh Marriott City Center and the Raleigh Convention Center)
919.834.5900, 800.849.8499
Provides official brochures, event calendars, special promotions, maps and other visitor information.
Hours: Mon.-Sat., 9am-5pm

Relocation Information

Greater Raleigh Chamber of Commerce

800 S. Salisbury St., P.O. Box 2978,
Raleigh 27602; 919.664.7000; Information:
919.664.7004; www.raleighchamber.org
Provides relocation packets, maps and information specific to the business community.
Hours: Mon.-Fri., 8:30am-5pm.

Other Wake County Chambers of Commerce

Apex, 919.362.6456
www.apexchamber.com

Cary, 919.467.1016
www.carychamber.com

Fuquay-Varina, 919.552.4947
www.fuquay-varina.com

Garner, 919.772.6440
www.garnerchamber.com

Holly Springs, 919.567.1796
www.hollyspringschamber.org

Knightdale, 919.266.4603
www.knightdalechamber.com

Morrisville, 919.463.7150
www.morrisvillenc.com

Rolesville, 919.562.7069
www.rolesvillechamber.org

Wake Forest, 919.556.1519
www.wakeforestchamber.org

Wendell, 919.365.6318
www.wendellchamber.com

Zebulon, 919.269.6320
www.zebulonchamber.org

Currency Exchange Outlets

Travelex

2600 John Brantley Blvd., RDU International Airport, Morrisville 27623; 919.840.0351
Terminal 2, Ticketing Lobby: 7am- 8pm
Terminal 2, Bag Claim: During international arrivals
www.travelex.com
Sells banknotes and other foreign exchange and travel-related products and services. Hours: Daily, 7am-8pm (Terminal 1), 3-6pm (Terminal 2).

Tax Information

- North Carolina sales tax is 6.75 percent as of July 1, 2014.
- Hotel and motel room rates within Wake County will have a six-percent local hotel occupancy tax added.
- Prepared food and beverages sold within Wake County will have a one percent prepared food and beverage tax added.

Transportation

Air Travel

RDU International Airport
2600 John Brantley Blvd., I-40 Exit 284, Morrisville 27623; 919.840.2123; www.rdu.com
Located about 15 miles from downtown Raleigh.

Airline Reservations

Air Canada
888.247.2262, www.aircanada.ca

American and American Eagle Airlines
800.433.7300, www.aa.com

Delta Airlines
800.221.1212, www.delta.com

JetBlue Airlines
800.538.2583, www.jetblue.com

Southwest Airlines, 800.435.9792
www.southwest.com

United Airlines
800.864.8331, www.united.com

US Airways
800.428.4322, www.usairways.com

Automobile Travel

American Automobile Association (AAA)
2301 Blue Ridge Rd., Raleigh 27607;
919.832.0543, 800.933.2621;
www.aaacarolinas.com

Bus Travel

Greyhound
2210 Capital Blvd., Raleigh 27604;
919.834.8275; www.greyhound.com

Local Transit

Cary Transit (C-Tran), 919.481.2020;
www.townofcary.org

GoRaleigh, 919.485.RIDE;
www.raleighnc.gov

GoTriangle, 919.485.RIDE,
http://gotriangle.org/

R-LINE (Downtown Raleigh circulator)
919.996.4036, www.yourhere.com

Wolfline, 919.515.WOLF
www.ncsu.edu/wolfline

RESOURCES FOR TRAVELERS

Taxis

For trips within Wake county, drivers charge a meter rate set by the RDU Airport Authority. Fares may either be charged on the meter rate or negotiated between you and the driver.

- \$3.50 initial charge (includes \$1 fuel fee)
- \$.65 for each additional 1/3 or fraction-of-a-mile thereafter
- \$.50 for each piece of luggage over three pieces-per-person
- \$5.45 for the first mile
- \$1.95 each additional mile

The average trip between RDU International Airport and downtown Raleigh costs approximately \$35.

Other Ground Options

Crank Arm Rickshaw, 919.291.0643, www.crankarmrickshaw.com

Raleigh Rickshaw, 919.623.5555 www.raleighrickshaw.com

Ray Price Harley-Davidson, 919.832.2261 www.rayprice.com

Triangle Glides, 919.828.1988 www.triangleglides.com

Trolley Pub, 919.473.3312 www.trolleypubraleigh.com

Train Travel

Amtrak
320 W. Cabarrus St., Raleigh 27601;
211 N. Academy St., Cary 27513;
800.872.7245; www.amtrak.com

Reservations required. Purchase tickets at the station, by phone or via the Internet.

Healthcare and Emergency Services

Primary Hospitals

Duke Health Raleigh Hospital
3400 Wake Forest Rd., Raleigh 27609;
919.954.3000;
www.dukeraleighhospital.org

Rex UNC Healthcare

4420 Lake Boone Tr., Rex Hospital
Main Campus, Raleigh 27607;
919.784.3100; www.rexhealth.com

WakeMed Health & Hospitals

3000 New Bern Ave., Raleigh Campus,
Raleigh 27610; 919.350.8000
1900 Kildaire Farm Rd., WakeMed Cary
Hospital, Cary 27518; 919.350.2300;
www.wakemed.org

Immediate Care Facilities

Accent Urgent Care

212 Ashville Ave., Ste. 10, Cary 27518;
919.859.1136

2406 Blue Ridge Rd., Ste. 190, Raleigh
27607; 919.789.4322

FastMed Urgent Care

2001 S. Main St., Wake Forest 27587;
919.562.3155

MedFirst Medical Center

2731-B Capital Blvd., Raleigh 27604;
919.878.4647

NextCare Urgent Care

6801 Pleasant Pines Dr., Raleigh 27613;
919.788.0099

4100 Wake Forest Rd., Raleigh 27609;
919.872.3959

1110 Kildaire Farm Rd., Cary 27511;
919.481.0277

811 U.S. Hwy. 70 W., Garner 27529;
919.779.5010

Raleigh Urgent Care

2600 New Bern Ave., Raleigh 27610;
919.231.3131

Rapid Response Urgent Care

220 U.S. Hwy. 70 W., Garner 27529;
919.779.7890

Rex Urgent Care

1515 S.W. Cary Pkwy., Ste. 130, Cary
27511; 919.387.3180

14501 New Falls of Neuse Rd., Raleigh
27614; 919.554.0213

Rx Urgent Care

3100 Blue Ridge Rd. #103, Raleigh 27612;
919.719.2250

Tremont Medical Center, PA

8312 Creedmoor Rd., Raleigh 27613;
919.846.7403

Extended-Hour Pharmacies

CVS

3914 Capital Blvd., Raleigh 27604;
919.876.5600; www.cvs.com; open 24 hrs.

Rite Aid

3432 Edwards Mill Rd., Raleigh 27612;
919.781.9571; www.riteaid.com;
open 24 hrs.

Walgreens

4408 New Bern Ave., Raleigh 27610;
919.231.6419; open 24 hrs.

511 W. Williams St., Apex 27502;
919.363.1471; open 24 hrs.

1401 N. Main St., Fuquay-Varina 27526;
919.567.2846; www.walgreens.com



Greater Raleigh Convention and Visitors Bureau

421 Fayetteville St.; Ste. 1505
Raleigh, North Carolina 27601

919.834.5900 • 800.849.8499

919.831.2887 FAX

www.visitRaleigh.com